

**AGREEMENT FOR LICENSE ADJACENT TO OR CROSSING COUNTY ROADS**

**STATE OF TEXAS §**

**COUNTY OF NAVARRO §**

**KNOW ALL MEN BY THESE PRESENTS:**

\_\_\_\_\_ NEXTLINK \_\_\_\_\_, **Owner** of a (pipeline, utility line, and gas or sewer line) hereby contracts and covenants with **Navarro County** ("**the County**") as follows:

I. \_\_\_\_\_ desires to construct and maintain a pipeline, utility line, or gas or sewer line in Navarro County, Texas and it is necessary to cross certain county road(s) SE CR-3240 and SE CR-3245 located in Precinct # 2, more fully described on the map attached hereto as Exhibit A and incorporated herein by reference. The license granted herein shall extend 5 feet on either side of the pipeline as it crosses the county road.

II. In consideration for **the County** granting permission through the issuance of a permit to lay a pipeline, utility line, or gas or sewer line adjacent to or crossing said county roads above described in Navarro County, Texas, the **Owner** hereby warrants, agrees and covenants that any crossing shall be constructed as follows:

All county road crossings shall be bored unless a variance is granted by Navarro County Commissioners Court, and lines underneath such roads shall be cased or otherwise constructed to provide maximum protection against damage or leaks. Owner may not block the county road during construction and must provide for at least one lane of traffic. The points where the pipeline crosses the road shall be clearly marked and the line shall be placed at a depth of no less than 6 feet underneath the lowest part of the **County's** bar ditches and/or road surfaces.

Type of Pipeline: FIBER OPTIC CABLE

The transport route (beginning and end) INSTALLING APPROX. 5254 FT OF FIBER OPTIC CABLE ALONG SE CR-3240 AND SE CR-3245.

- CROSSING SE CR-3245 AT INTERSECTIONS FM-309 AND SE CR-3240.
- CROSSING SE CR-3240 JUST NORTH OF INTERSECTION AT SWEETWATER TRAIL

(A detailed construction plan must be submitted with application)

Pipelines which run adjacent to a county road and which are within a county road easement shall be placed at a depth of no less than 6 feet underneath the lowest part of the **County's** bar ditches and/or road surfaces.

The pipeline shall be constructed in a safe and prudent manner and shall consist of only acceptable commercial pipeline materials. The **Owner** shall be responsible for maintaining the pipeline and the license area. In the event the pipeline is ever abandoned or ceases to be used for more than 6 consecutive months, this license shall terminate and revert to the **County**. In addition, if the pipeline is ever abandoned or ceases to be used for more than 6 consecutive months, the **Owner** shall, at the **County's** request, remove the pipeline from the license area and restore the property to its original condition.

**SEE ATTACHMENT "A" IF THIS IS FOR A PETROLEUM PIPELINE.**

III. In consideration of the granting of this license (pipeline, utility line, gas or sewer Line) adjacent to or across the **County's** roads, the **Owner** warrants and covenants that any damages which may be caused to County or adjacent property as a result of the construction, maintenance or operation of a pipeline shall be the sole responsibility of the **Owner** and the **Owner** warrants and covenants that the area where the construction takes place shall be repaired and put back in the same condition as it originally was before such construction took place.

IV. The **County** and **Owner** hereby covenant and agree that for each violation of this License agreement, **Owner** shall pay to the **County** liquidated damages in the amount of One Thousand Dollars (\$1,000.00) per day, per violation, until such violation have been corrected

and the County's requirements complied with. Such compliance shall be determined by the County Commissioner in whose precinct the work occurs.

V. **Owner**, at its own expense, shall maintain a general liability insurance policy in an amount sufficient to insure against loss or damages caused by the construction, maintenance and operation of the pipeline. The general liability insurance requirement may be met by a combination of self-insurance, primary, and excess insurance policies. **Owner** shall also, at its own expense, carry worker's compensation insurance as required by law.

VI. **Owner**, its successors and assigns agree to release, defend, indemnify, and hold harmless **the County** its respective commissioners, agents and employees (collectively, the "**Indemnified Parties**"), from any and all costs, losses, claims, judgments, settlements, and damages of every kind and character to real property, personal property or persons (including, without limitation, claims involving environmental laws and regulations, pollution, contamination of ground waters, personal injury and death), lawsuits and/or causes of action (including reasonable attorneys' fees, expert fees and court costs) (collectively "**Claims**"), which may grow out of, arise from, or in any manner be connected with the activities of **Owner's** agents, invitees, guests, contractors, servants and employees, on the license area, or any adjacent property, including, without limitation, any Claims arising from loss of subsurface support of any County road and any Claims arising from the production or transportation of materials through any pipeline. For purposes of this license, environmental laws and regulations include, without limitation, the federal Oil Pollution Act (OPA), the federal Comprehensive Environmental Response, Compensation and Liability Act (CERCLA), the federal Resource Conservation and Recovery Act (RCRA), the federal Clean Water Act, the Texas Solid Waste Disposal Act

(TSWDA), the Texas Water Code (TWC), and the federal, state and local rules, regulations, ordinances, orders and governmental directives implementing such statutes.

As used in this license, the term "**Hazardous Materials**" means any substance or material defined or identified as hazardous, extra-hazardous, toxic or radioactive or subject to regulation as a solid waste or pollutant under any applicable federal, state, or local statute or regulation including, without limitation, the environmental laws and regulations referenced herein. "**Remedial Work**" is defined as any site investigation or monitoring, any cleanup, containment, remediation, removal, or restoration work performed in response to any federal, state or local government authority or private party action ("**action**"), or pursuant to any federal, state or local statute, rule, regulation, ordinance, order, governmental directive or other laws ("**law**"). **Owner** agrees, for the benefit of **the County** and any adjacent surface owner, (1) to remove from the license area, if, as and when required by any action or law, any Hazardous Materials placed or released thereon by **Owner** (including its contractors), (2) to perform Remedial Work where the need therefore arises in connection with **Owner's** (including its contractors) operations or activities on the license area or any adjacent property, and (3) to comply in all respects with all laws governing operations by **Owner** (including its contractors) and Remedial Work on or associated with the license area and any adjacent property. Remedial Work shall be performed by one or more contractors selected by **Owner** under the supervision of an engineer selected by **Owner**. All costs and expenses of Remedial Work resulting from **Owner's** (including its drillers' and other contractors') operations shall be paid by **Owner**, including, without limitation, the charges of such contractors and/or the consulting engineer and **the County's** reasonable attorneys' fees and costs incurred in connection with the monitoring or

review of Remedial Work. If **Owner** shall fail to timely commence or cause to be commenced, or fail to diligently prosecute to completion, such Remedial Work, **the County** may (but shall not be required to), after first giving **Owner** thirty (30) days notice of its failure and **Owner's** continued failure to perform, cause such Remedial Work to be performed and **Owner** will reimburse all reasonable costs of same on demand. The provisions of this Article shall not constitute approval or obligate **The County** or the surface owner to consent to the imposition of any engineering or institutional control that would restrict or limit future use of the License area for any purpose including, without limitation, any deed restriction or limitation on the use of groundwater or use of the property for residential purposes. **Owner** will notify **the County** and surface owner of any claim or other action by any governmental agency or any third party involving the actual or alleged existence of Hazardous Materials on the License area or any adjoining property and provide **the County** and surface owner with copies of (1) any notice of any actual or threatened release of Hazardous Materials given by **Owner** pursuant to any law and (2) any report of and response to any such release including all Remedial Work. **Owner**, its successors and assigns, in accordance with the provisions of Article 8, will release, indemnify, pay and protect, defend and save the Indemnified Parties harmless from all claims, liabilities, fees and expenses of any kind (including reasonable attorneys' fees, expert fees and costs) that arise from the actual or alleged presence or release of any Hazardous Materials in connection with the operations of **Owner** and **Owner's** agents, invitees, guests, contractors, servants and employees on the License area or any adjacent property. Such indemnification shall include, without limitation, costs in connection with any Remedial Work performed by **the County**, surface owner, or any third party in response to any federal, state or governmental authority, laws

or regulations, due and payable upon demand by **the County** or adjacent surface owner.

**Owner's** obligations herein shall survive the termination of this License.

VII. This Agreement shall be binding upon and inure to the benefit of the parties and their respective heirs, executors, administrators, legal representatives, successors, and assigns.

VIII. This Agreement shall be construed under and in accordance with the laws of the State of Texas, and all obligations of the parties created by this Agreement are performable in Navarro County, Texas.

IX. In case any one or more of the provisions contained in this Agreement shall for any reason be held to be invalid, illegal, or unenforceable in any respect, this invalidity, illegality, or unenforceability shall not affect any other provision of the Agreement, and this Agreement shall be construed as if the invalid, illegal, or unenforceable provision had never been contained in the Agreement.

X. The rights and remedies provided by this Agreement are cumulative, and the use of any one right or remedy by either party shall not preclude or waive its right to use any or all other remedies. The rights and remedies provided in this Agreement are given in addition to any other rights the parties may have by law, statute, ordinance, or otherwise.

**EXECUTED** this 26<sup>th</sup> day of September, 2022

**OWNER**

**By: NATHAN WALTMAN, its VP of FIBER DEPLOYMENT**

**Company Name:** NEXTLINK

**Address:** 95 PARKER OAKS LANE

HUDSON OAKS, TX 76087

**Phone Number:** 682-789-787

NAVARRO COUNTY

By:

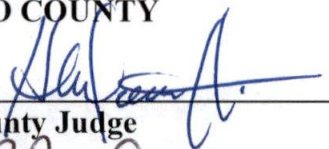
  
County Judge

By:

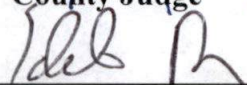
  
Commissioner of Precinct 2



SWEETWATER CIRCUIT FEED

KERENS, TX 75144  
GPS: LAT. 32.041455° / LONG. -96.182333°

CONSTRUCTION  
SEPTEMBER 09, 2022



SWEETWATERCIRCUITFEED\_KERENS\_TX\_CS\_001.DWG



MAP SHEET



LEGEND

|                        |  |
|------------------------|--|
| AERIAL                 |  |
| UNDERGROUND            |  |
| EXIST. NEXTLINK        |  |
| PULL-THRU EXIST.       |  |
| TO BE PLACED BY OTHERS |  |

**NEXTLINK**

SWEETWATER CIRCUIT FEED  
KERENS, TX 75114

CONSTRUCTION  
SEPTEMBER 09, 2022

SWEETWATERCIRCUITFEED\_KERENS\_TX\_MS\_002.DWG





## CONTACT SHEET - DRAWING INDEX

| NEXTLINK CONTACTS   |                   | DRAWING INDEX  |   |             |    |      |      |  |  |  |  |  |  |  |  |  |  |  |  |  |  |  |  |  |  |  |  |  |  |  |  |  |  |  |  |  |  |  |  |  |  |  |  |  |  |  |  |  |  |  |  |  |  |  |                                  |  |                             |                  |  |  |                                |  |  |               |                   |          |       |  |  |
|---|-------------------|--|---|-------------|----|------|------|--|--|--|--|--|--|--|--|--|--|--|--|--|--|--|--|--|--|--|--|--|--|--|--|--|--|--|--|--|--|--|--|--|--|--|--|--|--|--|--|--|--|--|--|--|--|--|----------------------------------|--|-----------------------------|------------------|--|--|--------------------------------|--|--|---------------|-------------------|----------|-------|--|--|
| REGIONAL VICE PRESIDENT:  |                   | DESCRIPTION  | SHEET NAME FILE NAME                                |             |    |      |      |  |  |  |  |  |  |  |  |  |  |  |  |  |  |  |  |  |  |  |  |  |  |  |  |  |  |  |  |  |  |  |  |  |  |  |  |  |  |  |  |  |  |  |  |  |  |  |                                  |  |                             |                  |  |  |                                |  |  |               |                   |          |       |  |  |
| OSP PROJECT MANAGER – TEXAS:<br>NATHAN WALTMAN<br>95 PARKER OAKS LN.<br>HUDSON OAKS, TX 76087<br><br>CELL: (682) 290–1988<br>E–MAIL: nwaltman@team.nxlink.com   |                   | COVER SHEET  | CS01 SWEETWATERCIRCUITFEED_KERENS_TX_CS_001.DWG     |             |    |      |      |  |  |  |  |  |  |  |  |  |  |  |  |  |  |  |  |  |  |  |  |  |  |  |  |  |  |  |  |  |  |  |  |  |  |  |  |  |  |  |  |  |  |  |  |  |  |  |                                  |  |                             |                  |  |  |                                |  |  |               |                   |          |       |  |  |
|   |                   | MAP SHEET  | MS01 SWEETWATERCIRCUITFEED_KERENS_TX_MS_002.DWG     |             |    |      |      |  |  |  |  |  |  |  |  |  |  |  |  |  |  |  |  |  |  |  |  |  |  |  |  |  |  |  |  |  |  |  |  |  |  |  |  |  |  |  |  |  |  |  |  |  |  |  |                                  |  |                             |                  |  |  |                                |  |  |               |                   |          |       |  |  |
|   |                   | CONTACT/DRAWING INDEX (THIS SHEET)   | CT01 SWEETWATERCIRCUITFEED–KEREN–TX_CT_003.DWG      |             |    |      |      |  |  |  |  |  |  |  |  |  |  |  |  |  |  |  |  |  |  |  |  |  |  |  |  |  |  |  |  |  |  |  |  |  |  |  |  |  |  |  |  |  |  |  |  |  |  |  |                                  |  |                             |                  |  |  |                                |  |  |               |                   |          |       |  |  |
|   |                   | GENERAL NOTES  | GND1 SWEETWATERCIRCUITFEED_KERENS_TX_GN_004.DWG     |             |    |      |      |  |  |  |  |  |  |  |  |  |  |  |  |  |  |  |  |  |  |  |  |  |  |  |  |  |  |  |  |  |  |  |  |  |  |  |  |  |  |  |  |  |  |  |  |  |  |  |                                  |  |                             |                  |  |  |                                |  |  |               |                   |          |       |  |  |
|   |                   | LEGEND & SYMBOLS   | LS01 SWEETWATERCIRCUITFEED_KERENS_TX_LS_005.DWG     |             |    |      |      |  |  |  |  |  |  |  |  |  |  |  |  |  |  |  |  |  |  |  |  |  |  |  |  |  |  |  |  |  |  |  |  |  |  |  |  |  |  |  |  |  |  |  |  |  |  |  |                                  |  |                             |                  |  |  |                                |  |  |               |                   |          |       |  |  |
|   |                   | DETAIL SHEETS  | DT01 SWEETWATERCIRCUITFEED_KERENS_TX_DT_006–008.DWG |             |    |      |      |  |  |  |  |  |  |  |  |  |  |  |  |  |  |  |  |  |  |  |  |  |  |  |  |  |  |  |  |  |  |  |  |  |  |  |  |  |  |  |  |  |  |  |  |  |  |  |                                  |  |                             |                  |  |  |                                |  |  |               |                   |          |       |  |  |
|   |                   | MATERIAL TAKE–OFF SHEET  | MRO1 SWEETWATERCIRCUITFEED_KERENS_TX_MR_009.DWG     |             |    |      |      |  |  |  |  |  |  |  |  |  |  |  |  |  |  |  |  |  |  |  |  |  |  |  |  |  |  |  |  |  |  |  |  |  |  |  |  |  |  |  |  |  |  |  |  |  |  |  |                                  |  |                             |                  |  |  |                                |  |  |               |                   |          |       |  |  |
|   |                   | OSP/ISP DESIGN SHEETS  | PO1 SWEETWATERCIRCUITFEED_KERENS_TX_OSP_001–012.DWG |             |    |      |      |  |  |  |  |  |  |  |  |  |  |  |  |  |  |  |  |  |  |  |  |  |  |  |  |  |  |  |  |  |  |  |  |  |  |  |  |  |  |  |  |  |  |  |  |  |  |  |                                  |  |                             |                  |  |  |                                |  |  |               |                   |          |       |  |  |
| BUILDING CONTACT(S):<br>XXXXX   |                   |  |   |             |    |      |      |  |  |  |  |  |  |  |  |  |  |  |  |  |  |  |  |  |  |  |  |  |  |  |  |  |  |  |  |  |  |  |  |  |  |  |  |  |  |  |  |  |  |  |  |  |  |  |                                  |  |                             |                  |  |  |                                |  |  |               |                   |          |       |  |  |
| BUILDING ENGINEER(S):<br>XXXXX  |                   |  |   |             |    |      |      |  |  |  |  |  |  |  |  |  |  |  |  |  |  |  |  |  |  |  |  |  |  |  |  |  |  |  |  |  |  |  |  |  |  |  |  |  |  |  |  |  |  |  |  |  |  |  |                                  |  |                             |                  |  |  |                                |  |  |               |                   |          |       |  |  |
| ENGINEER CONTACTS   |                   | PERMITTING AGENCIES  |   |             |    |      |      |  |  |  |  |  |  |  |  |  |  |  |  |  |  |  |  |  |  |  |  |  |  |  |  |  |  |  |  |  |  |  |  |  |  |  |  |  |  |  |  |  |  |  |  |  |  |  |                                  |  |                             |                  |  |  |                                |  |  |               |                   |          |       |  |  |
| ENGINEERING FIRM:<br>LJA TELECOM<br>6060 N CENTRAL EXPRESSWAY, SUITE 400<br>DALLAS, TEXAS 75206<br><br>OFFICE: (469) 621–0710<br>FAX: (469) 385–5164  |                   | NAVARRO COUNTY COMMISSIONER PCT 2<br>300 W 3RD AVE<br>SUITE #2<br>CORNICANA TX, 75110<br>EDDIE PERRY<br><br>OFFICE: (903) 654–3032<br>E–MAIL: Ksouthard@Navarracounty.org  |   |             |    |      |      |  |  |  |  |  |  |  |  |  |  |  |  |  |  |  |  |  |  |  |  |  |  |  |  |  |  |  |  |  |  |  |  |  |  |  |  |  |  |  |  |  |  |  |  |  |  |  |                                  |  |                             |                  |  |  |                                |  |  |               |                   |          |       |  |  |
| ENGINEERING CONTACT:<br>SR. PROJECT MANAGER:<br>KEN BAILEY<br>PROJECT MANAGER:<br>JOSH LENKER<br><br>CELL: (214) 551–5954<br>E–MAIL: kbailey@ljo.com<br>CELL: (469) 328–6180<br>E–MAIL: jlenker@ljo.com |                   | TEXAS DEPARTMENT OF TRANSPORTATION<br>4777 E. HWY 80<br>MESQUITE, TX. 75180<br>JUSTIN BRAUDRICK<br><br>OFFICE: (214) 320–6268<br>E–MAIL: justin.braudrick@txdot.gov  |   |             |    |      |      |  |  |  |  |  |  |  |  |  |  |  |  |  |  |  |  |  |  |  |  |  |  |  |  |  |  |  |  |  |  |  |  |  |  |  |  |  |  |  |  |  |  |  |  |  |  |  |                                  |  |                             |                  |  |  |                                |  |  |               |                   |          |       |  |  |
| CONSTRUCTION CONTACTS   |                   |  |   |             |    |      |      |  |  |  |  |  |  |  |  |  |  |  |  |  |  |  |  |  |  |  |  |  |  |  |  |  |  |  |  |  |  |  |  |  |  |  |  |  |  |  |  |  |  |  |  |  |  |  |                                  |  |                             |                  |  |  |                                |  |  |               |                   |          |       |  |  |
| CONSTRUCTION FIRM:<br>TO BE DETERMINED  |                   |  |   |             |    |      |      |  |  |  |  |  |  |  |  |  |  |  |  |  |  |  |  |  |  |  |  |  |  |  |  |  |  |  |  |  |  |  |  |  |  |  |  |  |  |  |  |  |  |  |  |  |  |  |                                  |  |                             |                  |  |  |                                |  |  |               |                   |          |       |  |  |
| CONSTRUCTION CONTACT:<br>TO BE DETERMINED   |                   |  |   |             |    |      |      |  |  |  |  |  |  |  |  |  |  |  |  |  |  |  |  |  |  |  |  |  |  |  |  |  |  |  |  |  |  |  |  |  |  |  |  |  |  |  |  |  |  |  |  |  |  |  |                                  |  |                             |                  |  |  |                                |  |  |               |                   |          |       |  |  |
| SPUJCING FIRM:<br>TO BE DETERMINED  |                   |  |   |             |    |      |      |  |  |  |  |  |  |  |  |  |  |  |  |  |  |  |  |  |  |  |  |  |  |  |  |  |  |  |  |  |  |  |  |  |  |  |  |  |  |  |  |  |  |  |  |  |  |  |                                  |  |                             |                  |  |  |                                |  |  |               |                   |          |       |  |  |
| * CONTACT 48 HOURS PRIOR TO CONSTRUCTION *  |                   |  |   |             |    |      |      |  |  |  |  |  |  |  |  |  |  |  |  |  |  |  |  |  |  |  |  |  |  |  |  |  |  |  |  |  |  |  |  |  |  |  |  |  |  |  |  |  |  |  |  |  |  |  |                                  |  |                             |                  |  |  |                                |  |  |               |                   |          |       |  |  |
| <div><div>LJA</div><div>LJA TELECOM</div></div>   |                   | <table><tr><th>REV</th><th>DESCRIPTION</th><th>BY</th><th>APVD</th><th>DATE</th></tr><tr><td> </td><td> </td><td> </td><td> </td><td> </td></tr><tr><td> </td><td> </td><td> </td><td> </td><td> </td></tr><tr><td> </td><td> </td><td> </td><td> </td><td> </td></tr><tr><td> </td><td> </td><td> </td><td> </td><td> </td></tr><tr><td> </td><td> </td><td> </td><td> </td><td> </td></tr><tr><td> </td><td> </td><td> </td><td> </td><td> </td></tr><tr><td> </td><td> </td><td> </td><td> </td><td> </td></tr><tr><td> </td><td> </td><td> </td><td> </td><td> </td></tr><tr><td> </td><td> </td><td> </td><td> </td><td> </td></tr></table> | REV   | DESCRIPTION | BY | APVD | DATE |  |  |  |  |  |  |  |  |  |  |  |  |  |  |  |  |  |  |  |  |  |  |  |  |  |  |  |  |  |  |  |  |  |  |  |  |  |  |  |  |  |  |  |  |  | <div><div>NEXTLINK</div><div>INFORMATION ON THIS DOCUMENT IS UNCLASSIFIED AND SHALL NOT BE RELEASED OR DISCLOSED IN WHOLE OR IN PART WITHOUT EXPRESS WRITTEN PERMISSION FROM THE U.S. GOVERNMENT</div></div> | <table><tr><td colspan="2">PROJECT: SWEETWATER CIRCUIT FEED</td><td>PROJECT CODE: LJA13107–0142</td></tr><tr><td colspan="3">KERENS, TX 75144</td></tr><tr><td colspan="3">TITLE: CONTACT AND INDEX SHEET</td></tr><tr><td>DRAWN: LJA/GM</td><td>DATE: JUL 10 2008</td><td>REV: 001</td></tr><tr><td>APPV:  </td><td> </td><td> </td></tr></table> | PROJECT: SWEETWATER CIRCUIT FEED |  | PROJECT CODE: LJA13107–0142 | KERENS, TX 75144 |  |  | TITLE: CONTACT AND INDEX SHEET |  |  | DRAWN: LJA/GM | DATE: JUL 10 2008 | REV: 001 | APPV: |  |  |
| REV   | DESCRIPTION       | BY   | APVD  | DATE        |    |      |      |  |  |  |  |  |  |  |  |  |  |  |  |  |  |  |  |  |  |  |  |  |  |  |  |  |  |  |  |  |  |  |  |  |  |  |  |  |  |  |  |  |  |  |  |  |  |  |                                  |  |                             |                  |  |  |                                |  |  |               |                   |          |       |  |  |
|   |                   |  |   |             |    |      |      |  |  |  |  |  |  |  |  |  |  |  |  |  |  |  |  |  |  |  |  |  |  |  |  |  |  |  |  |  |  |  |  |  |  |  |  |  |  |  |  |  |  |  |  |  |  |  |                                  |  |                             |                  |  |  |                                |  |  |               |                   |          |       |  |  |
|   |                   |  |   |             |    |      |      |  |  |  |  |  |  |  |  |  |  |  |  |  |  |  |  |  |  |  |  |  |  |  |  |  |  |  |  |  |  |  |  |  |  |  |  |  |  |  |  |  |  |  |  |  |  |  |                                  |  |                             |                  |  |  |                                |  |  |               |                   |          |       |  |  |
|   |                   |  |   |             |    |      |      |  |  |  |  |  |  |  |  |  |  |  |  |  |  |  |  |  |  |  |  |  |  |  |  |  |  |  |  |  |  |  |  |  |  |  |  |  |  |  |  |  |  |  |  |  |  |  |                                  |  |                             |                  |  |  |                                |  |  |               |                   |          |       |  |  |
|   |                   |  |   |             |    |      |      |  |  |  |  |  |  |  |  |  |  |  |  |  |  |  |  |  |  |  |  |  |  |  |  |  |  |  |  |  |  |  |  |  |  |  |  |  |  |  |  |  |  |  |  |  |  |  |                                  |  |                             |                  |  |  |                                |  |  |               |                   |          |       |  |  |
|   |                   |  |   |             |    |      |      |  |  |  |  |  |  |  |  |  |  |  |  |  |  |  |  |  |  |  |  |  |  |  |  |  |  |  |  |  |  |  |  |  |  |  |  |  |  |  |  |  |  |  |  |  |  |  |                                  |  |                             |                  |  |  |                                |  |  |               |                   |          |       |  |  |
|   |                   |  |   |             |    |      |      |  |  |  |  |  |  |  |  |  |  |  |  |  |  |  |  |  |  |  |  |  |  |  |  |  |  |  |  |  |  |  |  |  |  |  |  |  |  |  |  |  |  |  |  |  |  |  |                                  |  |                             |                  |  |  |                                |  |  |               |                   |          |       |  |  |
|   |                   |  |   |             |    |      |      |  |  |  |  |  |  |  |  |  |  |  |  |  |  |  |  |  |  |  |  |  |  |  |  |  |  |  |  |  |  |  |  |  |  |  |  |  |  |  |  |  |  |  |  |  |  |  |                                  |  |                             |                  |  |  |                                |  |  |               |                   |          |       |  |  |
|   |                   |  |   |             |    |      |      |  |  |  |  |  |  |  |  |  |  |  |  |  |  |  |  |  |  |  |  |  |  |  |  |  |  |  |  |  |  |  |  |  |  |  |  |  |  |  |  |  |  |  |  |  |  |  |                                  |  |                             |                  |  |  |                                |  |  |               |                   |          |       |  |  |
|   |                   |  |   |             |    |      |      |  |  |  |  |  |  |  |  |  |  |  |  |  |  |  |  |  |  |  |  |  |  |  |  |  |  |  |  |  |  |  |  |  |  |  |  |  |  |  |  |  |  |  |  |  |  |  |                                  |  |                             |                  |  |  |                                |  |  |               |                   |          |       |  |  |
| PROJECT: SWEETWATER CIRCUIT FEED  |                   | PROJECT CODE: LJA13107–0142  |   |             |    |      |      |  |  |  |  |  |  |  |  |  |  |  |  |  |  |  |  |  |  |  |  |  |  |  |  |  |  |  |  |  |  |  |  |  |  |  |  |  |  |  |  |  |  |  |  |  |  |  |                                  |  |                             |                  |  |  |                                |  |  |               |                   |          |       |  |  |
| KERENS, TX 75144  |                   |  |   |             |    |      |      |  |  |  |  |  |  |  |  |  |  |  |  |  |  |  |  |  |  |  |  |  |  |  |  |  |  |  |  |  |  |  |  |  |  |  |  |  |  |  |  |  |  |  |  |  |  |  |                                  |  |                             |                  |  |  |                                |  |  |               |                   |          |       |  |  |
| TITLE: CONTACT AND INDEX SHEET  |                   |  |   |             |    |      |      |  |  |  |  |  |  |  |  |  |  |  |  |  |  |  |  |  |  |  |  |  |  |  |  |  |  |  |  |  |  |  |  |  |  |  |  |  |  |  |  |  |  |  |  |  |  |  |                                  |  |                             |                  |  |  |                                |  |  |               |                   |          |       |  |  |
| DRAWN: LJA/GM   | DATE: JUL 10 2008 | REV: 001   |   |             |    |      |      |  |  |  |  |  |  |  |  |  |  |  |  |  |  |  |  |  |  |  |  |  |  |  |  |  |  |  |  |  |  |  |  |  |  |  |  |  |  |  |  |  |  |  |  |  |  |  |                                  |  |                             |                  |  |  |                                |  |  |               |                   |          |       |  |  |
| APPV:   |                   |  |   |             |    |      |      |  |  |  |  |  |  |  |  |  |  |  |  |  |  |  |  |  |  |  |  |  |  |  |  |  |  |  |  |  |  |  |  |  |  |  |  |  |  |  |  |  |  |  |  |  |  |  |                                  |  |                             |                  |  |  |                                |  |  |               |                   |          |       |  |  |



### GENERAL NOTES

| APPLICABLE CODES  | CABLE VAULT INSTALLATION NOTES:  | PROJECT INFORMATION | NEXTLINK GENERAL NOTES:   |
|---|--|---------------------|---|
| AMERICAN ASSOCIATION OF STATE HIGHWAY AND TRANSPORTATION OFFICIALS - LATEST EDITION<br>OCCUPATIONAL SAFETY AND HEALTH STANDARDS - LATEST EDITION<br>MANUAL ON UNIFORM TRAFFIC CONTROL DEVICES | 1. FOR LOCATION AND ORIENTATION OF CABLE VAULTS, SEE NETWORK ROUTE PLAN.<br>2. ALL OPENINGS, PENETRATIONS AND JOINTS IN CABLE VAULTS SEALED WITH A NON-SHRINK GROUT TO FORM A WATER-TIGHT CABLE VAULT.<br>3. CABLE VAULTS INSTALLED ON A BASE CONSISTING OF CLEAN GRAVEL OR CRUSHED STONE. THE MINIMUM THICKNESS OF THE BASE SHALL BE TWELVE INCHES (12").<br>4. FINISHED SURFACE REPAIRED TO A CONDITION EQUAL TO OR GREATER THAN ORIGINAL CONDITIONS.<br>5. BOTTOM OF EXCAVATION COMPACTED AND LEVELED PRIOR TO CABLE VAULT INSTALLATION.<br>6. PLACE THE VAULT SO THAT THE COVER IS AT THE DESIRED GRADE ELEVATION. |                     | 1. THE CONTRACTOR SHALL BE SOLELY RESPONSIBLE FOR ALL CONSTRUCTION MEANS, METHODS, TECHNIQUES, PROCEDURES, AND SEQUENCES FOR COORDINATING ALL PORTIONS OF THE WORK UNDER THE CONTRACT.<br>2. THE CONTRACTOR SHALL VISIT THE JOB SITE TO REVIEW THE SCOPE OF WORK AND EXISTING JOB SITE CONDITIONS.<br>3. THE CONTRACTOR SHALL VERIFY ALL EXISTING CONDITIONS AND DIMENSIONS PRIOR TO SUBMITTING A BID. ANY DISCREPANCIES, CONFLICTS, OR OMISSIONS, SHALL BE REPORTED TO PROJECT MANAGER BEFORE PROCEEDING WITH THE WORK.<br>4. THE CONTRACTOR SHALL PROTECT ALL AREAS FROM DAMAGE WHICH MAY OCCUR DURING CONSTRUCTION. ANY DAMAGE BY CONTRACTOR TO NEW AND EXISTING CONSTRUCTION, STRUCTURE, LANDSCAPING, OR EQUIPMENT SHALL BE IMMEDIATELY REPAIRED OR REPLACED TO THE SATISFACTION OF THE ROW OWNER AND PROJECT MANAGER AT THE EXPENSE OF THE CONTRACTOR.<br>5. THE CONTRACTOR SHALL BE RESPONSIBLE FOR, AND SHALL REPLACE OR REMEDY, ANY FAULTY, IMPROPER, OR INFERIOR MATERIALS OR WORKMANSHIP OR ANY DAMAGE WHICH SHALL APPEAR WITHIN ONE YEAR AFTER THE COMPLETION AND ACCEPTANCE OF THE WORK UNDER THIS CONTRACT.<br>6. THE CONTRACTOR SHALL REMOVE ALL RUBBISH AND WASTE MATERIALS ON A REGULAR BASIS, AND SHALL EXERCISE STRICT CONTROL OVER JOB CLEANING THROUGHOUT CONSTRUCTION UP TO COMPLETION OF WORK.<br>7. IT SHALL BE THE RESPONSIBILITY OF THE CONTRACTOR TO LOCATE ALL EXISTING UTILITIES ADJACENT TO OR CROSSING THE NETWORK ROUTE, WHETHER SHOWN HEREIN OR NOT, AND TO PROTECT THEM FROM DAMAGE. THE CONTRACTOR SHALL BEAR ALL EXPENSES FOR REPAIR OR REPLACEMENT OF UTILITIES OR OTHER PROPERTY DAMAGED BY CONTRACTOR IN CONJUNCTION WITH THE EXECUTION OF WORK.<br>8. THE CONTRACTOR SHALL BE RESPONSIBLE FOR THE COMPLETE SECURITY OF THE SITE WHILE THE JOB IS IN PROGRESS AND UNTIL THE JOB IS COMPLETED.<br>9. THE CONTRACTOR SHALL PROVIDE TEMPORARY WATER, POWER, AND TOILET FACILITIES AS REQUIRED BY THE CITY OR GOVERNING AGENCY.<br>10. THE CONTRACTOR SHALL NOTIFY PROJECT MANAGER IF DETAILS ARE CONSIDERED UNSUITABLE, UNSAFE, NOT WATERPROOF, OR NOT WITHIN CUSTOMARY TRADE PRACTICE. IF WORK IS PERFORMED, IT WILL BE ASSUMED THAT THERE IS NO OBJECTION TO THE DETAIL. DETAILS ARE INTENDED TO SHOW THE END RESULT OF THE DESIGN. MINOR MODIFICATIONS MAY BE REQUIRED TO SUIT JOB CONDITIONS, AND SHALL BE INCLUDED AS PART OF THE WORK.<br>11. ALL SYMBOLS AND ABBREVIATIONS USED ON THE DRAWINGS ARE CONSIDERED CONSTRUCTION STANDARDS. IF THE CONTRACTOR HAS QUESTIONS REGARDING THEIR EXACT MEANING, TECH GROUP SHALL BE NOTIFIED FOR CLARIFICATION BEFORE PROCEEDING WITH THE WORK.<br>12. ALL GRADES SHOWN AS PROPOSED FINISHED GRADES INCLUDE SURFACE TREATMENTS SUCH AS TOPSOIL OR PAVEMENT. MAKE ALLOWANCES DURING EARTHWORK OPERATIONS FOR THESE SURFACE TREATMENTS.<br>13. ALL WORK SHOWN ON THE OSP DRAWINGS SHALL BE ACCOMPLISHED IN ACCORDANCE WITH THE REQUIREMENTS OF SPECIFICATION 02000 - FOG OSP - CONDUIT SYSTEMS. |
| CITY GENERAL NOTES:   |  | GENERAL COMMENTS    |   |

| ENGINEERING CONTRACTOR | REV | DESCRIPTION | BY | APVD | DATE |
|------------------------|-----|-------------|----|------|------|
|                        | --  | --          | -- | --   | --   |
|                        | --  | --          | -- | --   | --   |
|                        | --  | --          | -- | --   | --   |
|                        | --  | --          | -- | --   | --   |
|                        | --  | --          | -- | --   | --   |

PROJECT: SWEETWATER CIRCUIT FEED  
KERENS, TX 75144  
PROJECT OWNER: LJA73107-0142

REVISIONS:

| NO. | DESCRIPTION | DATE     |
|-----|-------------|----------|
| 004 | OF 008      | 05/25/22 |

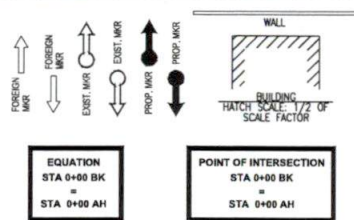

STATION TIC MARK-OTHERS (O-TIC-UP) 0+00  
 STATION TIC MARK-OTHERS (O-TIC-DN) 0+00  
 STATION TIC MARK (TIC-UP) 0+00  
 STATION TIC MARK (TIC-DN) 0+00

CAUTION NOTE  
 UG UTILITIES  
 CAUTION !!!  
 IN AREA

PROP. AERIAL SPLICE POINT

EXIST. AERIAL SPLICE POINT

PROP. AERIAL CABLE SLACK LOOP

PLACE 100' AERIAL SLACK LOOP

EXIST. AERIAL CABLE SLACK LOOP

PROP-UTIL-POLE-WITH-RISER

X-UTIL-POLE-WITH-RISER

OVERHEAD GUY

AERIAL SPAN FOOTAGES

EXIST. ANCHOR AND GUY

EXIST. S/W ANCHOR AND GUY

PROP. ANCHOR AND GUY

PROP. S/W ANCHOR AND GUY

REMOVE SYMBOL (REM)

CITY LIMIT SIGN

SIGN

SIGN 2 (2 POST SIGN)  
 SIGN 3 (BRICK SIGN)

TREE

TREE LINE OR BUSH  
 IRRIGATION CONTROL VALVE  
 WATER VAULT  
 FIRE HYDRANT  
 WATER SPRINKLER  
 WATER METER  
 WATER VALVE  
 GAS METER  
 GAS VALVE  
 EXIST. HH  
 PROP. 36"x60"x48" HH (REGULAR HANDHOLE)

PROP. CABINET  
 EXIST. MH  
 PROP. 4'x4'x4' MH  
 SANITARY SEWER CLEAN OUT  
 UNKNOWN MH

E-MH  
 SS-MH  
 WW-MH  
 STM-MH  
 W-MH  
 TEL-CABINET  
 PROP-TEL-MH  
 TEL-MH  
 TEL-PED  
 TEL-HH  
 CATV-MH  
 CATV-PED  
 STM-INLET

STM-INLET  
 STM-DRAIN  
 STDR 2 (STM DRAIN GRATE WITH CONCRETE AROUND IT)  
 STREET LIGHT

TRAFFIC SIGNAL LIGHT POLE  
 PROP. UTILITY POLE  
 PROP-UTIL-POLE-WITH-RISER  
 X-UTIL-POLE  
 X-UTIL-POLE-WITH-RISER  
 ELECTRIC METER  
 ELECTRIC CABINET  
 UTIL-HH  
 UNK. VAULT  
 ROW-MKR  
 PARKING METER  
 PULLBOX  
 MAIL BOX  
 R/R SIGNAL BOX  
 R/R X-ING  
 CELL TOWER

## LEGEND OF SYMBOLS

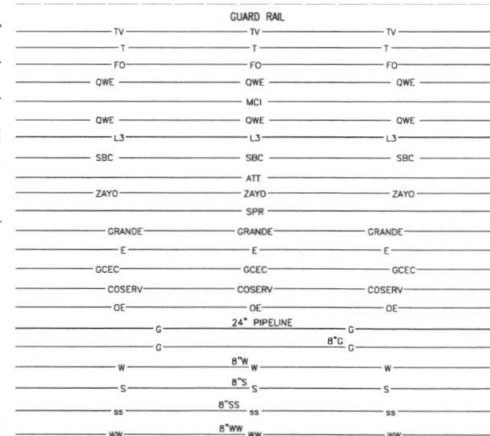
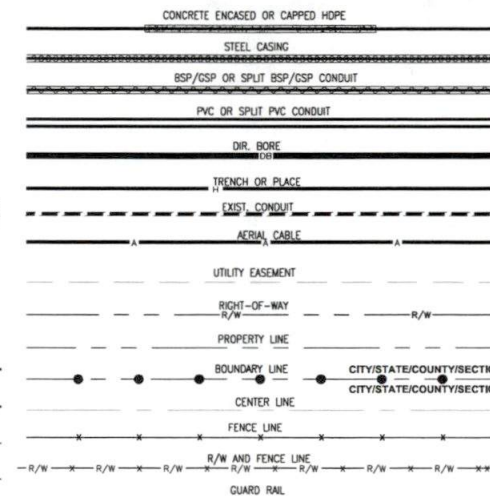
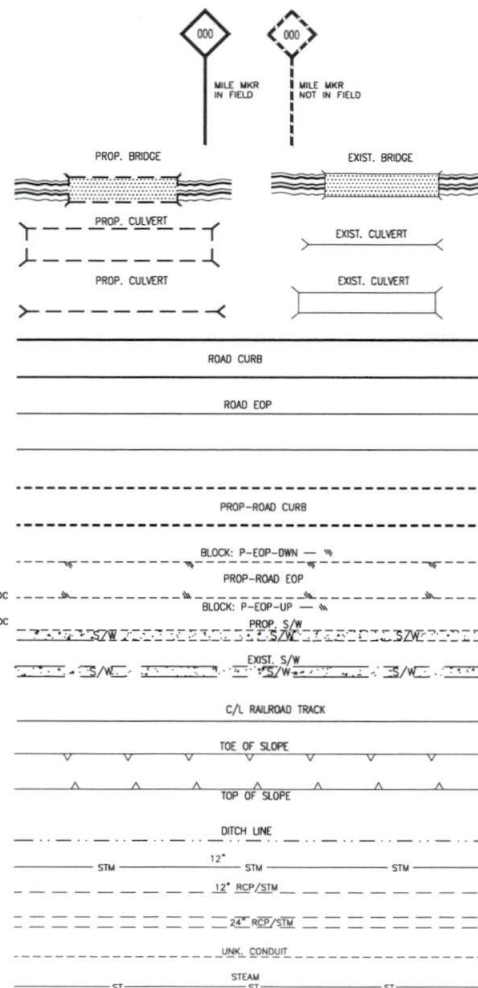

| REV | DESCRIPTION | BY | APVD | DATE |
|-----|-------------|----|------|------|
| 1   |             |    |      |      |
| 2   |             |    |      |      |
| 3   |             |    |      |      |
| 4   |             |    |      |      |
| 5   |             |    |      |      |
| 6   |             |    |      |      |
| 7   |             |    |      |      |
| 8   |             |    |      |      |
| 9   |             |    |      |      |
| 10  |             |    |      |      |



|                                  |                            |
|----------------------------------|----------------------------|
| PROJECT: SWEETWATER CIRCUIT FEED | PROJECT ORG: LJA73107-0142 |
| KERENS, TX 75144                 |                            |
| TITLE: LEGEND AND SYMBOLS        |                            |
| DRAWN LJA/GM                     | CHECKED J. J. JONES        |
| APPROVED                         | DATE 05/08/22              |



## TYPICAL CONSTRUCTION DETAILS

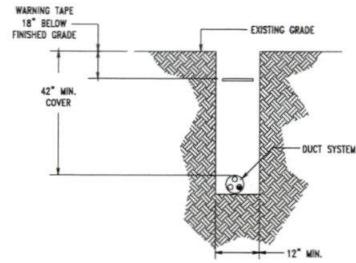

NOTE: BACKFILL WITH NATIVE ROCK FREE MATERIAL OR AS DIRECTED BY CITY  
COMPACT TO DENSITY REQUIRED BY CITY

**TYPICAL TRENCH IN EARTH**  
N.T.S.

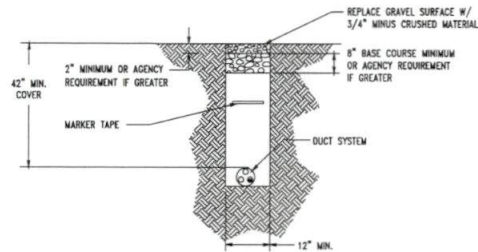

NOTE: BACKFILL WITH NATIVE ROCK FREE MATERIAL OR AS DIRECTED BY CITY  
COMPACT TO 95%

**TYPICAL TRENCH IN GRAVEL**  
N.T.S.

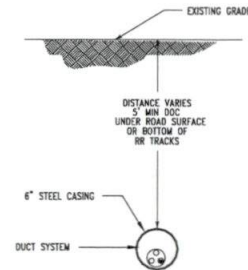

**TYPICAL JACK AND BORE**  
N.T.S.

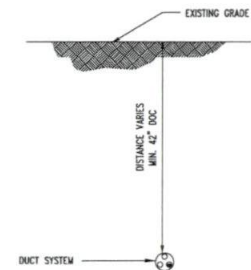

**TYPICAL DIRECTIONAL BORE**  
N.T.S.

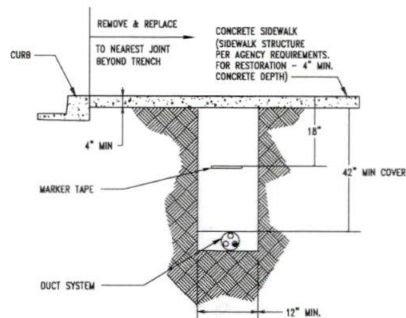

BACKFILL:  
AS PER AGENCY

**CONCRETE SIDEWALK RESTORATION**  
N.T.S.

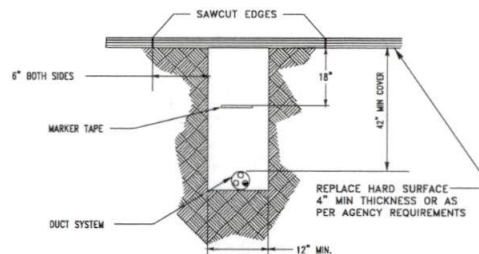

BACKFILL:  
AS PER AGENCY

**ASPHALT PAVEMENT RESTORATION**  
N.T.S.

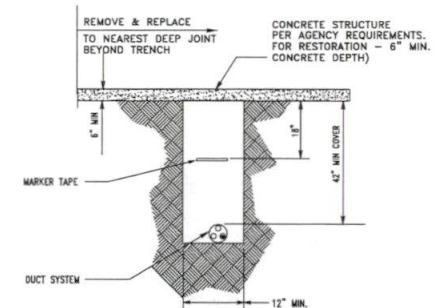

BACKFILL:  
AS PER AGENCY

**CONCRETE PAVEMENT RESTORATION**  
N.T.S.



| REV | DESCRIPTION | BY | APVD | DATE |
|-----|-------------|----|------|------|
|     |             |    |      |      |
|     |             |    |      |      |
|     |             |    |      |      |
|     |             |    |      |      |
|     |             |    |      |      |
|     |             |    |      |      |
|     |             |    |      |      |
|     |             |    |      |      |
|     |             |    |      |      |



|                                  |                |               |
|----------------------------------|----------------|---------------|
| PROJECT: SWEETWATER CIRCUIT FEED |                | PROJECT NO:   |
| KERENS, TX 75144                 |                | LJAT3107-0142 |
| TITLE: TYPICAL TRENCH DETAILS    |                |               |
| DRAWN: LJA/GM                    | DATE: 08/08/22 | REV:          |
| APPROVED:                        |                |               |
| SHEET: 005 OF 009                | APPROVED:      | 08/08/22      |

## TYPICAL BORE DETAILS

(CROSSING ROAD/DRIVEWAY)  
2-1.25" HDPE E/W FIBER OPTIC CABLE

2-1.25" HDPE E/W FIBER OPTIC CABLE

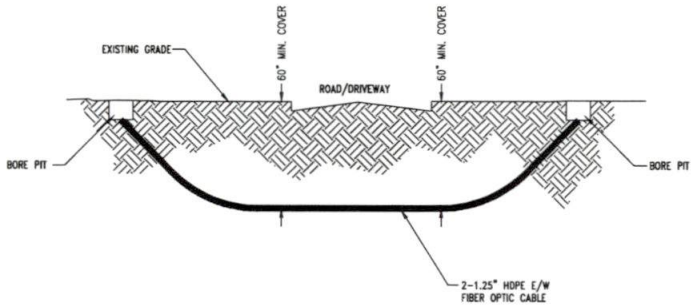

2-1.25" HOPE E/W FIBER OPTIC CABLE

2-1.25" HOPE E/W FIBER OPTIC CABLE

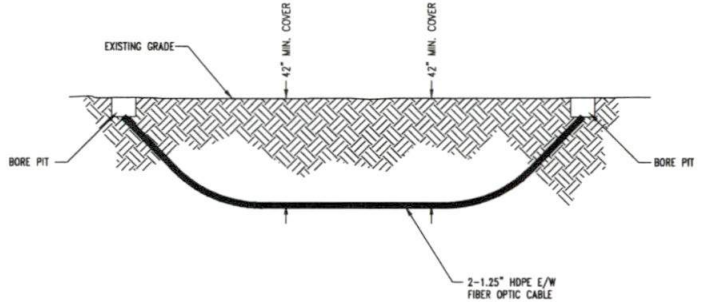

|   |     |             |    |      |      |   |                                     |                             |  |
|---|-----|-------------|----|------|------|---|-------------------------------------|-----------------------------|--|
| ENGINEERING CONTRACTOR:   | REV | DESCRIPTION | BY | APVD | DATE |  | PROJECT: SWEETWATER CIRCUIT FEED    | PROJECT CODE: LJAT3107-0142 |  |
|    | --  | --          | -- | --   | --   |   | KERENS, TX 75144                    |                             |  |
|   |     |             |    |      |      |   | TITLE:                              |                             |  |
|   |     |             |    |      |      |   | TYPICAL BORE DETAILS                |                             |  |
|   |     |             |    |      |      |   | DRAWN LJA/GM                        |                             |  |
|   |     |             |    |      |      |   | DWG NO.                             |                             |  |
|   |     |             |    |      |      |   | SWEETWATERCIRCUITFEED_KERENS_TX.DWG |                             |  |
|   |     |             |    |      |      |   | REV                                 |                             |  |
|   |     |             |    |      |      |   | APVD                                |                             |  |
|   |     |             |    |      |      |   | SHEETS 007 OF 008                   |                             |  |
|   |     |             |    |      |      | APPROVED CARRIER: 08/08/22  |                                     |                             |  |
| INFORMATION ON THIS DOCUMENT IS PROPRIETARY AND SHALL NOT BE COPIED, REPRODUCED OR DISCLOSED IN WHOLE OR IN PART WITHOUT WRITTEN CONSENT OF CARRIER |     |             |    |      |      |   |                                     |                             |  |

# TYPICAL 24"x36"x24" HANDHOLE DETAIL

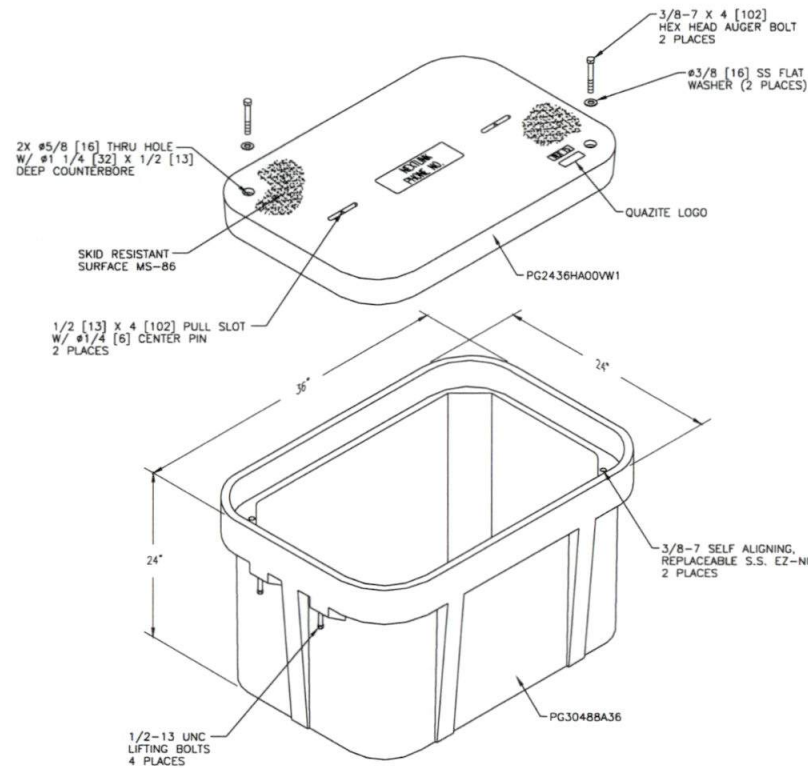

NEXTLINK  
PHONE NUMBER  
LOGO DETAIL

- NOTE:
1. CUSTOMER IS NEXTLINK  
LOGO TO BE SPECIFIED: NEXTLINK / PHONE NUMBER
  2. THIS ASSEMBLY IS RATED FOR A STATIC DESIGN  
LOAD OF 15,000 LBS. [66,720 N] OVER A 10 [254]  
X 10 [254] AREA AND MUST PASS A MIN. STATIC  
TEST LOAD OF 22,500 LBS. [100,085 N].
  3. THIS ASSEMBLY SHALL MEET ANSI/SCTE 77 TIER  
15 SPECIFICATIONS.



| REV | DESCRIPTION | BY | APVD | DATE |
|-----|-------------|----|------|------|
|     |             |    |      |      |
|     |             |    |      |      |
|     |             |    |      |      |
|     |             |    |      |      |
|     |             |    |      |      |
|     |             |    |      |      |
|     |             |    |      |      |



INFORMATION ON THE EXISTING  
OR IMPROVED AND SHALL BE  
REPRODUCED IN WHOLE OR IN PART  
WITHOUT WRITTEN CONSENT OF LJA

|   |                                  |
|---|----------------------------------|
| PROJECT: SWEETWATER CIRCUIT FEED            | PROJECT CODE: LJA13107-0142      |
| KERENS, TX 75144                            |                                  |
| TITLE: TYPICAL 24"x36"x24" HANDHOLE DETAILS |                                  |
| DRAWN: LJA/GM                               | DATE: 05/25/22                   |
| APPROVED: [Signature]                       | BY: [Signature]                  |
| SHEET: 008 OF 008                           | APPROVED ORIGINAL NAME: 05/25/22 |

# MATERIAL RAKE-OFF SHEET

## OUTSIDE PLANT

| DESCRIPTION                               | QUANTITY | UNITS | NOTES\COMMENTS |
|---|----------|-------|----------------|
| 12ct FIBER OPTIC CABLE (AERIAL)           | -        | L.F.  |                |
| 12ct FIBER OPTIC CABLE (RISER)            | -        | L.F.  |                |
| 12ct FIBER OPTIC CABLE (U/G)              | 6481     | L.F.  |                |
| 6M STRAND                                 | -        | L.F.  |                |
| OVERHEAD GUY                              | -        | L.F.  |                |
| 1-4" GALVANIZE U-GUARD E/W 2-1.25" HDPE   | -        | L.F.  |                |
| DOWN GUY & ANCHOR                         | -        | EACH  |                |
| AERIAL SLACK LOOP                         | -        | L.F.  |                |
| TRENCH 2-1.25" HDPE                       | 10       | L.F.  |                |
| DIRECTIONAL BORE 2-1.25" HDPE             | 6291     | L.F.  |                |
| DIR. BORE 1-4" HDPE CASING                | 180      | L.F.  |                |
| 1.25" HDPE                                | 12962    | L.F.  |                |
| 10GA TRACER WIRE                          | 6481     | L.F.  |                |
| 24"x36"x36" HANDHOLE                      | 10       | EACH  |                |
| 30"x48"x36" HANDHOLE                      | -        | EACH  |                |
| 36"x60"x48" MANHOLE                       | -        | EACH  |                |
| PULL CABLE THRU EXISTING CUSTOMER CONDUIT | -        | L.F.  |                |
| 4" CORE BORE                              | -        | EACH  |                |
| SLACK COIL IN HANDHOLE/MANHOLE            | 1000     | L.F.  |                |
| REMOVE & RESTORE CONCRETE SIDEWALK        | -        | S.F.  |                |
| REMOVE & RESTORE CONCRETE PAVEMENT        | -        | S.F.  |                |
| REMOVE & RESTORE ASPHALT PAVEMENT         | -        | S.F.  |                |
| 12ct FIBER OPTIC CABLE (TOTAL)            | 7481     | L.F.  |                |

## INSIDE PLANT

| DESCRIPTION                               | QUANTITY | UNITS | NOTES\COMMENTS |
|---|----------|-------|----------------|
| PULL CABLE THRU EXISTING CUSTOMER CONDUIT | -        | L.F.  |                |
| 2" PLENUM RATED INNERDUCT                 | -        | L.F.  |                |
| 1.25" E.M.T.                              | -        | L.F.  |                |
| JUNCTION BOX                              | -        | EACH  |                |
| PULL BOX(ES)                              | -        | EACH  |                |
| 288 FIBER CABLE                           | -        | L.F.  |                |

ENGINEERING CONTRACTOR



| REV | DESCRIPTION | BY | APVD | DATE |
|-----|-------------|----|------|------|
| -   | -           | -  | -    | -    |
| -   | -           | -  | -    | -    |
| -   | -           | -  | -    | -    |
| -   | -           | -  | -    | -    |
| -   | -           | -  | -    | -    |
| -   | -           | -  | -    | -    |
| -   | -           | -  | -    | -    |
| -   | -           | -  | -    | -    |
| -   | -           | -  | -    | -    |



INFORMATION ON THIS DOCUMENT  
IS UNCLASSIFIED AND SHALL BE  
RECEIVED BY STATE OF TEXAS  
NOTICE: WITHOUT CONSENT OF CHARTER

|                                  |                                  |
|----------------------------------|----------------------------------|
| PROJECT: SWEETWATER CIRCUIT FEED | PROJECT CODE: LJA73107-0142      |
| KERENS, TX 75144                 |                                  |
| SHEET: MATERIAL RAKE-OFF SHEET   |                                  |
| DRAWN: LJA/GM                    | DATE: 05/28/22                   |
| APPROVED: [Signature]            | DATE: 05/28/22                   |
| SHEET: 005 OF 008                | APPROVED ORIGINAL NAME: 05/28/22 |



NOTE:  
UNDERGROUND UTILITIES HAVE BEEN PLOTTED FROM AVAILABLE  
RECORDS AND FIELD OBSERVATIONS BUT ARE NOT NECESSARILY EXACT.  
IT IS THE CONTRACTOR RESPONSIBILITY TO FIELD LOCATE ALL  
UNDERGROUND OBSTRUCTIONS AND UTILITIES PRIOR TO CONSTRUCTION.  
COMPLETE REPAIR OF ANY AND ALL DAMAGES INCURRED SHALL BE AT  
THE EXPENSE OF THE CONTRACTOR.

# NAVARRO COUNTY KERENS, TX

SEE PROFILE ON  
SHEET 01A

CAUTION !!!  
CONTRACTOR TO LOCATE &  
VERIFY ALL EXISTING UTILITIES  
PRIOR TO CONSTRUCTION

CAUTION !!!  
EXIST. BURIED FIBER, TELEPHONE, CATV, GAS, ELECTRIC, WATER,  
SANITARY SEWER & STORM SEWER FACILITIES IN CONSTRUCTION AREA  
AND HAVE NOT BEEN FIELD LOCATED. CONTRACTOR TO VERIFY EXACT  
LOCATION AND DEPTH PRIOR TO ANY DIGGING AND/OR BORING.

CONTRACTOR:  
IT IS YOUR RESPONSIBILITY TO CALL THE TXDOT INSPECTOR  
48 HOURS PRIOR TO START OF CONSTRUCTION

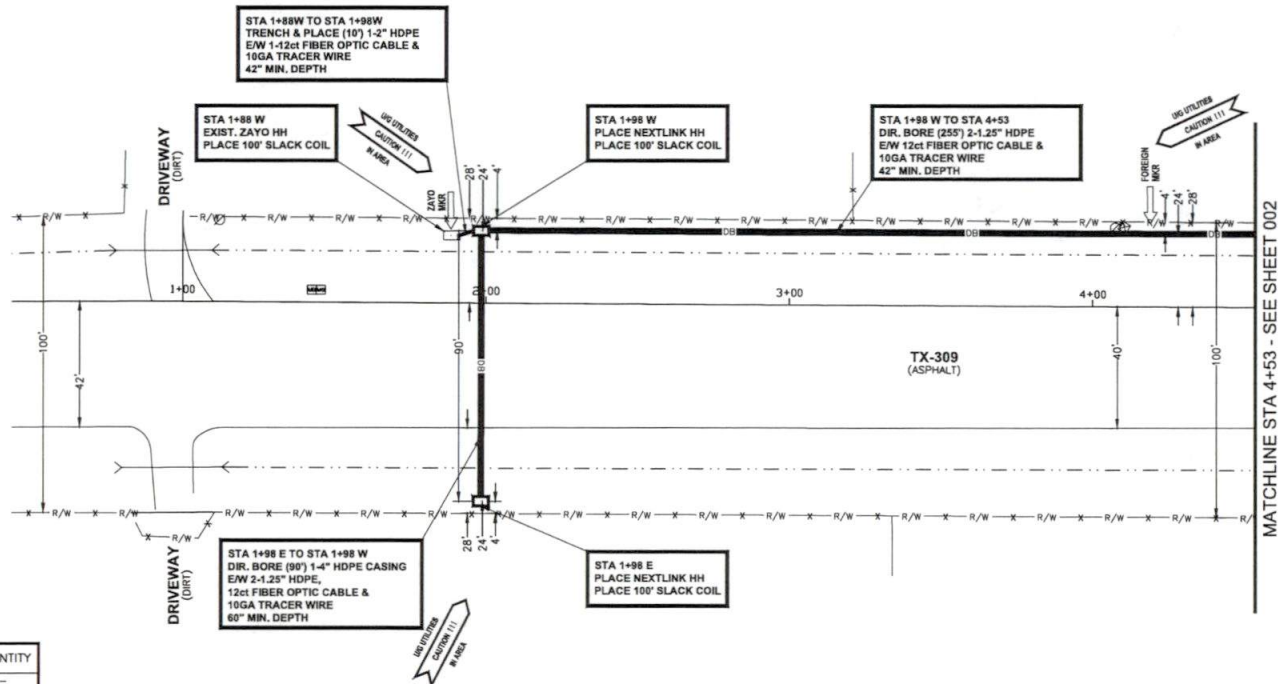

| DESCRIPTION                             | UNIT | QUANTITY |
|---|------|----------|
| 12ct FIBER OPTIC CABLE (AERIAL)         | FT   | -        |
| 12ct FIBER OPTIC CABLE (RISER)          | FT   | -        |
| 12ct FIBER OPTIC CABLE NEW (U/G)        | FT   | 355      |
| 6M STRAND                               | FT   | -        |
| 1-4" GALV. U-GUARD E/W 2-1.25" HDPE     | FT   | -        |
| DOWN GUY & ANCHOR                       | EA   | -        |
| OVERHEAD GUY                            | FT   | -        |
| AERIAL SLACK LOOP                       | FT   | -        |
| TRENCH 2-1.25" HDPE                     | LF   | 10       |
| DIR. BORE 2-1.25" HDPE                  | LF   | 255      |
| DIR. BORE 1-4" HDPE CASING              | LF   | 90       |
| 1.25" HDPE                              | FT   | 710      |
| 10GA TRACER WIRE                        | FT   | 355      |
| 24"X36"X24" HH                          | EA   | 2        |
| 3'X5'X4" MH                             | EA   | -        |
| PULL CABLE THRU EXIST. AT&T CONDUIT     | FT   | -        |
| PULL CABLE THRU EXIST. NEXTLINK CONDUIT | FT   | -        |
| 1-4" CORE BORE                          | EA   | -        |
| SLACK COIL IN HH/MH                     | FT   | 200      |
| REMOVE & RESTORE CONCRETE S/W           | SF   | -        |
| REMOVE & RESTORE CONCRETE PAVEMENT      | SF   | -        |
| REMOVE & RESTORE ASPHALT PAVEMENT       | SF   | -        |
| 12ct FIBER OPTIC CABLE (TOTAL)          | FT   | 555      |



CALL BEFORE YOU DIG  
1-800-455-4545  
48 HOURS NOTICE REQUIRED



| REV | DESCRIPTION | BY | APVD | DATE |
|-----|-------------|----|------|------|
| -   | -           | -  | -    | -    |
| -   | -           | -  | -    | -    |
| -   | -           | -  | -    | -    |
| -   | -           | -  | -    | -    |
| -   | -           | -  | -    | -    |
| -   | -           | -  | -    | -    |
| -   | -           | -  | -    | -    |



Information on this document  
is proprietary and shall not  
be used, copied, reproduced or  
distributed in whole or in part  
without written consent of owner

|                                     |   |
|-------------------------------------|---|
| PROJECT: SWEETWATER CIRCUIT FEED    | PROJECT NO.: LJA13107-0142                      |
| KERENS, TX 75114                    |   |
| TITLE: FIBER OPTIC CABLE BUILD PLAN |   |
| DRAWN: LJA/CM                       | CWE NO. SWEETWATERCIRCUITFEED_KERENS_TX_001.DWG |
| APPY: -                             | REV: -  |
| SHEETS: 001 OF 012                  | APPROVED: 09/29/22                              |

# NAVARRO COUNTY

KERENS, TX

PROFILE  
CROSSING TX-309  
LOOKING SOUTH.

SCALE  
HOR: 1" = 40'  
VER: 1" = 10'

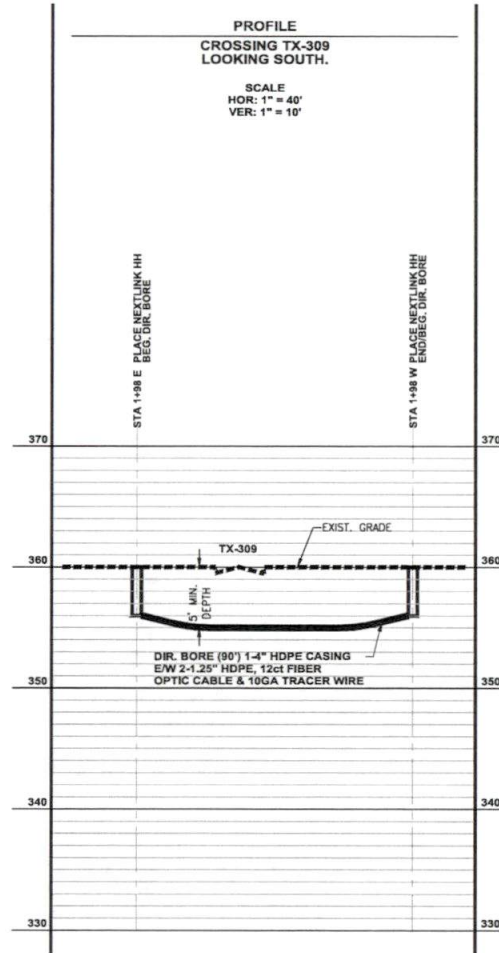

CALL BEFORE YOU DIG  
1-800-545-4345  
48 HOURS NOTICE REQUIRED

ENGINEERING CONTRACTOR



| REV | DESCRIPTION | BY | APVD | DATE |
|-----|-------------|----|------|------|
|     |             |    |      |      |
|     |             |    |      |      |
|     |             |    |      |      |
|     |             |    |      |      |
|     |             |    |      |      |
|     |             |    |      |      |
|     |             |    |      |      |
|     |             |    |      |      |
|     |             |    |      |      |



|  |                             |
|--|-----------------------------|
| PROJECT: SWEETWATER CIRCUIT FEED       | PROJECT NAME: LJA13107-0142 |
| KERENS, TX 75114                       |                             |
| TITLE: FIBER OPTIC CABLE BUILD PROFILE |                             |
| DRAWN: LJA/GM                          | DWG NO: -                   |
| APPV: -                                | DATE: 08/25/22              |
| SHEET: 014 OF 012                      | APPROVED: [Signature]       |

NOTE:  
UNDERGROUND UTILITIES HAVE BEEN PLOTTED FROM AVAILABLE RECORDS AND FIELD OBSERVATIONS BUT ARE NOT NECESSARILY EXACT. IT IS THE CONTRACTOR RESPONSIBILITY TO FIELD LOCATE ALL UNDERGROUND OBSTRUCTIONS AND UTILITIES PRIOR TO CONSTRUCTION. COMPLETE REPAIR OF ANY AND ALL DAMAGES INCURRED SHALL BE AT THE EXPENSE OF THE CONTRACTOR.

# NAVARRO COUNTY KERENS, TX

SEE PROFILE ON  
SHEET 02A

CAUTION !!!  
CONTRACTOR TO LOCATE &  
VERIFY ALL EXISTING UTILITIES  
PRIOR TO CONSTRUCTION

CAUTION!!!  
EXIST. BURIED FIBER, TELEPHONE, CATV, GAS, ELECTRIC, WATER,  
SANITARY SEWER & STORM SEWER FACILITIES IN CONSTRUCTION AREA  
AND HAVE NOT BEEN FIELD LOCATED. CONTRACTOR TO VERIFY EXACT  
LOCATION AND DEPTH PRIOR TO ANY DIGGING AND/OR BORING.

CONTRACTOR:  
IT IS YOUR RESPONSIBILITY TO CALL THE TxDOT INSPECTOR  
48 HOURS PRIOR TO START OF CONSTRUCTION

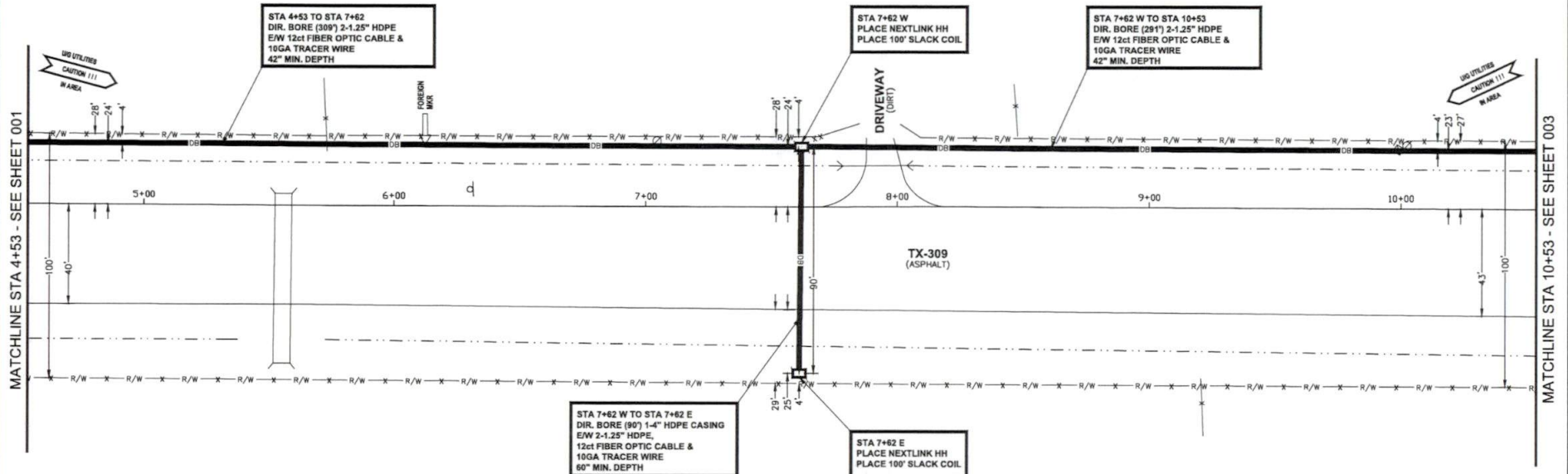

| DESCRIPTION                             | UNIT | QUANTITY |
|---|------|----------|
| 12ct FIBER OPTIC CABLE (AERIAL)         | FT   | -        |
| 12ct FIBER OPTIC CABLE (RISER)          | FT   | -        |
| 12ct FIBER OPTIC CABLE NEW (U/G)        | FT   | 690      |
| 6M STRAND                               | FT   | -        |
| 1-4" GALV. U-GUARD E/W 2-1.25" HDPE     | FT   | -        |
| DOWN GUY & ANCHOR                       | EA   | -        |
| OVERHEAD GUY                            | FT   | -        |
| AERIAL SLACK LOOP                       | FT   | -        |
| TRENCH 2-1.25" HDPE                     | LF   | -        |
| DIR. BORE 2-1.25" HDPE                  | LF   | 600      |
| DIR. BORE 1-4" HDPE CASING              | LF   | 90       |
| 1.25" HDPE                              | FT   | 1380     |
| 10GA TRACER WIRE                        | FT   | 690      |
| 24"X36"X24" HH                          | EA   | 2        |
| 3"X5"X4" MH                             | EA   | -        |
| PULL CABLE THRU EXIST. AT&T CONDUIT     | FT   | -        |
| PULL CABLE THRU EXIST. NEXTLINK CONDUIT | FT   | -        |
| 1-4" CORE BORE                          | EA   | -        |
| SLACK COIL IN HH/MH                     | FT   | 200      |
| REMOVE & RESTORE CONCRETE S/W           | SF   | -        |
| REMOVE & RESTORE CONCRETE PAVEMENT      | SF   | -        |
| REMOVE & RESTORE ASPHALT PAVEMENT       | SF   | -        |
| 12ct FIBER OPTIC CABLE (TOTAL)          | FT   | 890      |



CALL BEFORE YOU DIG  
1-800-545-4545  
48 HOURS NOTICE REQUIRED



| REV | DESCRIPTION | BY | APVD | DATE |
|-----|-------------|----|------|------|
| 1   |             |    |      |      |
| 2   |             |    |      |      |
| 3   |             |    |      |      |
| 4   |             |    |      |      |
| 5   |             |    |      |      |
| 6   |             |    |      |      |
| 7   |             |    |      |      |
| 8   |             |    |      |      |
| 9   |             |    |      |      |
| 10  |             |    |      |      |



INFORMATION ON THIS DOCUMENT  
IS FOR INFORMATION ONLY AND NOT  
TO BE USED FOR ANY OTHER PURPOSE  
UNLESS SO INDICATED IN THE PLAN  
WHICH WOULD BE THE BASIS OF CLAIM

|                                  |                             |
|----------------------------------|-----------------------------|
| PROJECT: SWEETWATER CIRCUIT FEED | PROJECT NAME: LJA73107-0142 |
| KERENS, TX 75114                 |                             |
| FIBER OPTIC CABLE BUILD          |                             |
| PLAN                             |                             |
| DRAWN LJA/GH                     | DATE: 08/29/22              |
| APPROVED                         |                             |
| SHEET: 005 OF 012                | APPROVED: 08/29/22          |

# NAVARRO COUNTY

KERENS, TX

## PROFILE

CROSSING TX-309  
LOOKING SOUTH.

SCALE  
HOR: 1" = 40'  
VER: 1" = 10'

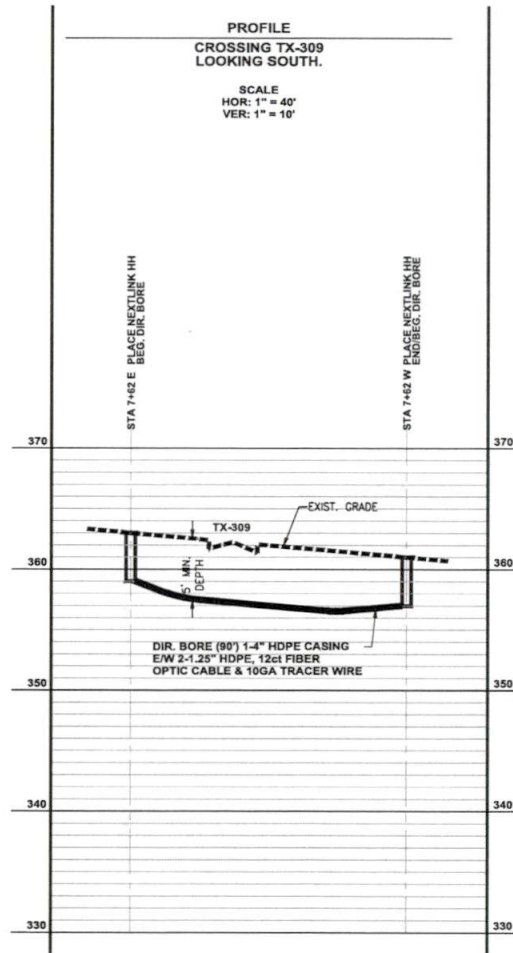

CALL BEFORE YOU DIG  
1-800-245-4345  
48 HOURS NOTICE REQUIRED

ENGINEERING CONTRACTOR



| REV | DESCRIPTION | BY | APVD | DATE |
|-----|-------------|----|------|------|
|     |             |    |      |      |
|     |             |    |      |      |
|     |             |    |      |      |
|     |             |    |      |      |
|     |             |    |      |      |
|     |             |    |      |      |
|     |             |    |      |      |
|     |             |    |      |      |
|     |             |    |      |      |



INFORMATION ON THIS DOCUMENT  
IS PRELIMINARY AND SHALL NOT  
BE USED, COPIED, REPRODUCED OR  
DISCLOSED IN WHOLE OR IN PART  
WITHOUT WRITTEN CONSENT OF CORNER

|  |   |
|--|---|
| PROJECT: SWEETWATER CIRCUIT FEED       | PROJECT NAME: LJA13107-0142             |
| KERENS, TX 75114                       |   |
| TITLE: FIBER OPTIC CABLE BUILD PROFILE |   |
| DRAWN LJA/DM                           | DWG NO: -                               |
| APPV -                                 | SWEETWATERCIRCUITFEED_KERENS_TX_02A.DWG |
| SHEET 02A OF 012                       | DATE: 09/09/22                          |



NOTE:  
UNDERGROUND UTILITIES HAVE BEEN PLOTTED FROM AVAILABLE RECORDS AND FIELD OBSERVATIONS BUT ARE NOT NECESSARILY EXACT. IT IS THE CONTRACTOR RESPONSIBILITY TO FIELD LOCATE ALL UNDERGROUND OBSTRUCTIONS AND UTILITIES PRIOR TO CONSTRUCTION. COMPLETE REPAIR OF ANY AND ALL DAMAGES INCURRED SHALL BE AT THE EXPENSE OF THE CONTRACTOR.

NAVARRO COUNTY  
KERENS, TX

CAUTION !!!  
CONTRACTOR TO LOCATE & VERIFY ALL EXISTING UTILITIES PRIOR TO CONSTRUCTION

CAUTION !!!  
EXIST. BURIED FIBER, TELEPHONE, CATV, GAS, ELECTRIC, WATER, SANITARY SEWER & STORM SEWER FACILITIES IN CONSTRUCTION AREA AND HAVE NOT BEEN FIELD LOCATED. CONTRACTOR TO VERIFY EXACT LOCATION AND DEPTH PRIOR TO ANY DIGGING AND/OR BORING.

CONTRACTOR:  
IT IS YOUR RESPONSIBILITY TO CALL THE TxDOT INSPECTOR 48 HOURS PRIOR TO START OF CONSTRUCTION

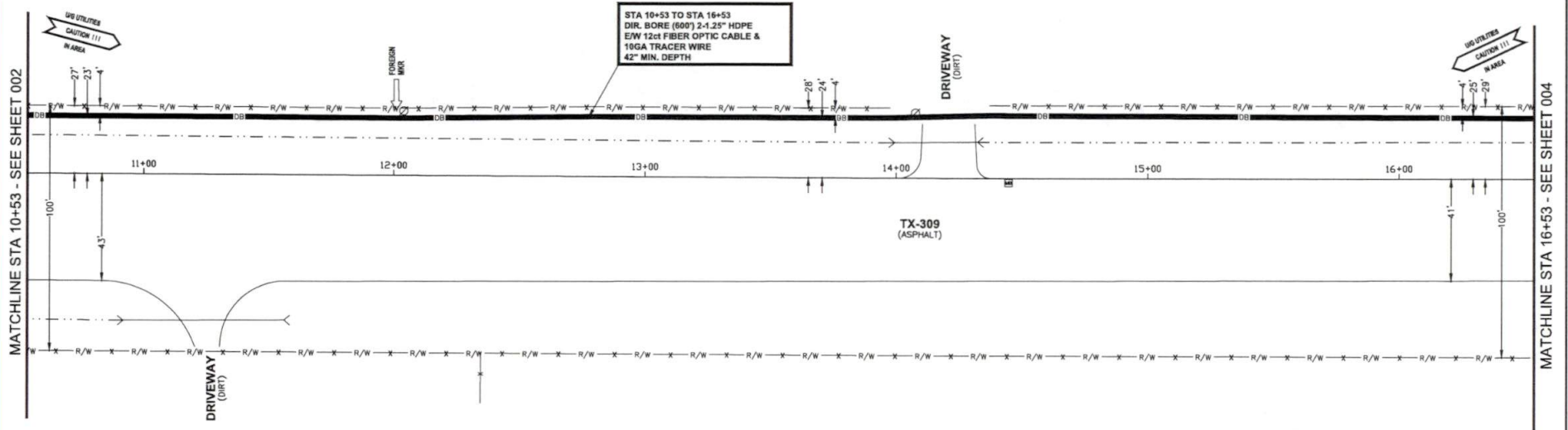

| DESCRIPTION                             | UNIT | QUANTITY |
|---|------|----------|
| 12ct FIBER OPTIC CABLE (AERIAL)         | FT   | -        |
| 12ct FIBER OPTIC CABLE (RISER)          | FT   | -        |
| 12ct FIBER OPTIC CABLE NEW (U/G)        | FT   | 600      |
| 6M STRAND                               | FT   | -        |
| 1-4\" GALV. U-GUARD E/W 2-1.25\" HDPE   | FT   | -        |
| DOWN GUY & ANCHOR                       | EA   | -        |
| OVERHEAD GUY                            | FT   | -        |
| AERIAL SLACK LOOP                       | FT   | -        |
| TRENCH 2-1.25\" HDPE                    | LF   | -        |
| DIR. BORE 2-1.25\" HDPE                 | LF   | 600      |
| DIR. BORE 1-4\" HDPE CASING             | LF   | -        |
| 1.25\" HDPE                             | FT   | 1200     |
| 10GA TRACER WIRE                        | FT   | 600      |
| 24\"X36\"X24\" HH                       | EA   | -        |
| 3'X5'X4\" MH                            | EA   | -        |
| PULL CABLE THRU EXIST. AT&T CONDUIT     | FT   | -        |
| PULL CABLE THRU EXIST. NEXTLINK CONDUIT | FT   | -        |
| 1-4\" CORE BORE                         | EA   | -        |
| SLACK COIL IN HH/MH                     | FT   | -        |
| REMOVE & RESTORE CONCRETE S/W           | SF   | -        |
| REMOVE & RESTORE CONCRETE PAVEMENT      | SF   | -        |
| REMOVE & RESTORE ASPHALT PAVEMENT       | SF   | -        |
| 12ct FIBER OPTIC CABLE (TOTAL)          | FT   | 600      |



CALL BEFORE YOU DIG  
1-800-245-4545  
48 HOURS NOTICE REQUIRED



| REV | DESCRIPTION | BY | APVD | DATE |
|-----|-------------|----|------|------|
| -   | -           | -  | -    | -    |
| -   | -           | -  | -    | -    |
| -   | -           | -  | -    | -    |
| -   | -           | -  | -    | -    |
| -   | -           | -  | -    | -    |
| -   | -           | -  | -    | -    |
| -   | -           | -  | -    | -    |
| -   | -           | -  | -    | -    |
| -   | -           | -  | -    | -    |



Information on this document is preliminary and shall not be used, copied, reproduced or disclosed in whole or in part without written consent of owner.

|                                  |                             |
|----------------------------------|-----------------------------|
| PROJECT: SWEETWATER CIRCUIT FEED | PROJECT CODE: LJAT3107-0142 |
| KERENS, TX 75114                 |                             |
| FIBER OPTIC CABLE BUILD PLAN     |                             |
| DRAWN: LJA/GW                    | DATE: 08/08/22              |
| APPV: -                          | DATE: 08/08/22              |
| SHEET: 003 OF 012                | DATE: 08/08/22              |

NOTE:  
UNDERGROUND UTILITIES HAVE BEEN PLOTTED FROM AVAILABLE RECORDS AND FIELD OBSERVATIONS BUT ARE NOT NECESSARILY EXACT. IT IS THE CONTRACTOR RESPONSIBILITY TO FIELD LOCATE ALL UNDERGROUND OBSTRUCTIONS AND UTILITIES PRIOR TO CONSTRUCTION. COMPLETE REPAIR OF ANY AND ALL DAMAGES INCURRED SHALL BE AT THE EXPENSE OF THE CONTRACTOR.

# NAVARRO COUNTY KERENS, TX

CAUTION!!!  
CONTRACTOR TO LOCATE & VERIFY ALL EXISTING UTILITIES PRIOR TO CONSTRUCTION

CAUTION!!!  
EXIST. BURIED FIBER, TELEPHONE, CATV, GAS, ELECTRIC, WATER, SANITARY SEWER & STORM SEWER FACILITIES IN CONSTRUCTION AREA AND HAVE NOT BEEN FIELD LOCATED. CONTRACTOR TO VERIFY EXACT LOCATION AND DEPTH PRIOR TO ANY DIGGING AND/OR BORING.



CONTRACTOR:  
IT IS YOUR RESPONSIBILITY TO CALL THE TxDOT INSPECTOR 48 HOURS PRIOR TO START OF CONSTRUCTION

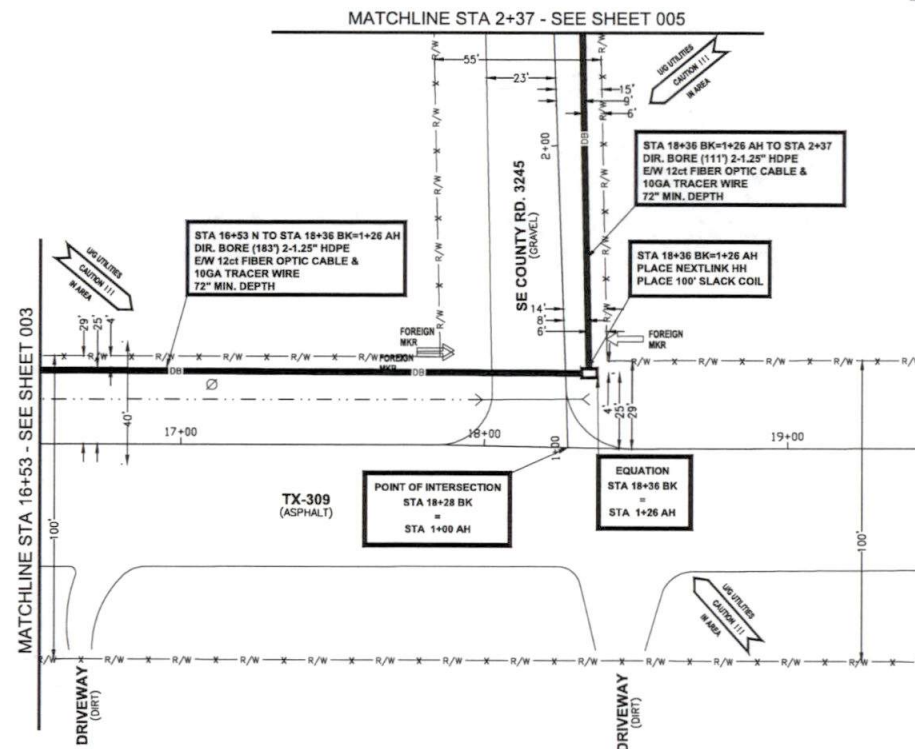

| DESCRIPTION                             | UNIT | QUANTITY |
|---|------|----------|
| 12ct FIBER OPTIC CABLE (AERIAL)         | FT   | —        |
| 12ct FIBER OPTIC CABLE (RISER)          | FT   | —        |
| 12ct FIBER OPTIC CABLE NEW (U/G)        | FT   | 294      |
| 6M STRAND                               | FT   | —        |
| 1-4" GALV. U-GUARD E/W 2-1.25" HDPE     | EA   | —        |
| DOWN GUY & ANCHOR                       | FT   | —        |
| OVERHEAD GUY                            | FT   | —        |
| AERIAL SLACK LOOP                       | FT   | —        |
| TRENCH 2-1.25" HDPE                     | LF   | —        |
| DIR. BORE 2-1.25" HDPE                  | LF   | 294      |
| DIR. BORE 1-4" HDPE CASING              | LF   | —        |
| 1.25" HDPE                              | FT   | 588      |
| 10GA TRACER WIRE                        | EA   | 294      |
| 24"x36"x24" HH                          | EA   | 1        |
| 3'X5'X4" MH                             | —    | —        |
| PULL CABLE THRU EXIST. AT&T CONDUIT     | FT   | —        |
| PULL CABLE THRU EXIST. NEXTLINK CONDUIT | FT   | —        |
| 1-4" CORE BORE                          | EA   | —        |
| SLACK COIL IN HH/MH                     | FT   | 100      |
| REMOVE & RESTORE CONCRETE S/W           | SF   | —        |
| REMOVE & RESTORE CONCRETE PAVEMENT      | SF   | —        |
| REMOVE & RESTORE ASPHALT PAVEMENT       | SF   | —        |
| 12ct FIBER OPTIC CABLE (TOTAL)          | FT   | 104      |



CALL BEFORE YOU DIG  
1-800-245-4545  
48 HOURS NOTICE REQUIRED



| REV | DESCRIPTION | BY | APVD | DATE |
|-----|-------------|----|------|------|
| 1   |             |    |      |      |
| 2   |             |    |      |      |
| 3   |             |    |      |      |
| 4   |             |    |      |      |
| 5   |             |    |      |      |
| 6   |             |    |      |      |
| 7   |             |    |      |      |
| 8   |             |    |      |      |
| 9   |             |    |      |      |
| 10  |             |    |      |      |



INFORMATION ON THIS DOCUMENT IS PRELIMINARY AND SHALL NOT BE USED FOR CONSTRUCTION OR OTHER PURPOSES WITHOUT THE WRITTEN CONSENT OF THE ENGINEER.

|                                     |                             |
|-------------------------------------|-----------------------------|
| PROJECT: SWEETWATER CIRCUIT FEED    | PROJECT 0000                |
| LOCATION: KERENS, TX 75114          | PROJECT 0000                |
| TITLE: FIBER OPTIC CABLE BUILD PLAN | PROJECT 0000                |
| DRAWN: LJA/GH                       | DATE: 05/09/21              |
| APPROVED: [Signature]               | DATE: 05/09/21              |
| REVISIONS:                          |                             |
| NO. 004 OF 012                      | APPROVED ORIGINAL: 05/09/21 |

NOTE:  
UNDERGROUND UTILITIES HAVE BEEN PLOTTED FROM AVAILABLE RECORDS AND FIELD OBSERVATIONS BUT ARE NOT NECESSARILY EXACT. IT IS THE CONTRACTOR RESPONSIBILITY TO FIELD LOCATE ALL UNDERGROUND OBSTRUCTIONS AND UTILITIES PRIOR TO CONSTRUCTION. COMPLETE REPAIR OF ANY AND ALL DAMAGES INCURRED SHALL BE AT THE EXPENSE OF THE CONTRACTOR.

NAVARRO COUNTY  
KERENS, TX

CAUTION!!!!  
CONTRACTOR TO LOCATE & VERIFY ALL EXISTING UTILITIES PRIOR TO CONSTRUCTION

CAUTION!!!!  
EXIST. BURIED FIBER, TELEPHONE, CATV, GAS, ELECTRIC, WATER, SANITARY SEWER & STORM SEWER FACILITIES IN CONSTRUCTION AREA AND HAVE NOT BEEN FIELD LOCATED. CONTRACTOR TO VERIFY EXACT LOCATION AND DEPTH PRIOR TO ANY DIGGING AND/OR BORING.

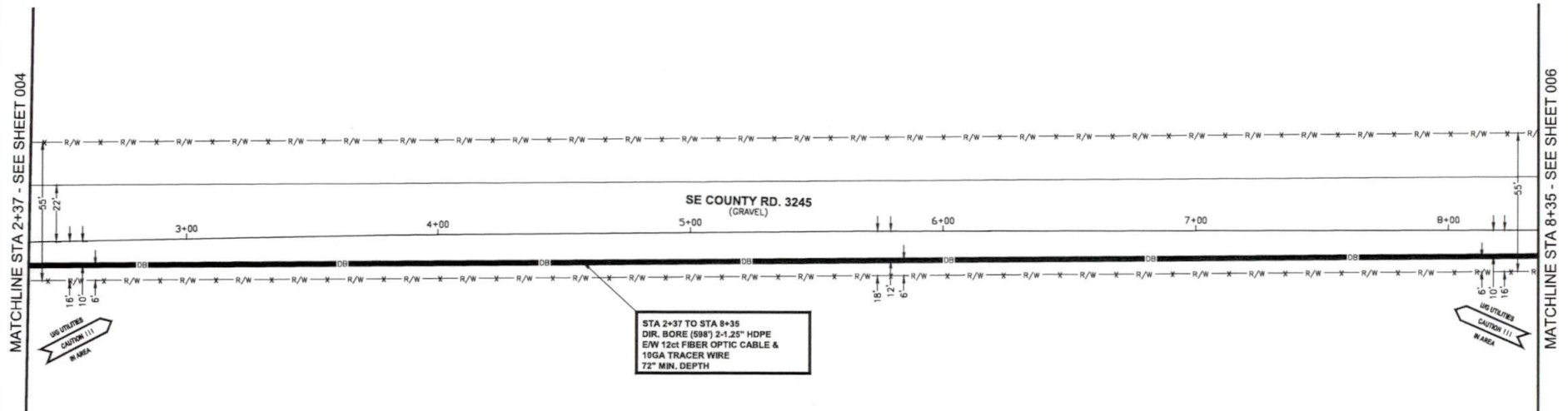

| DESCRIPTION                             | UNIT | QUANTITY |
|---|------|----------|
| 12ct FIBER OPTIC CABLE (AERIAL)         | FT   | -        |
| 12ct FIBER OPTIC CABLE (RISER)          | FT   | -        |
| 12ct FIBER OPTIC CABLE NEW (U/G)        | FT   | 600      |
| 6M STRAND                               | FT   | -        |
| 1-4" GALV. U-GUARD E/W 2-1.25" HDPE     | FT   | -        |
| DOWN GUY & ANCHOR                       | EA   | -        |
| OVERHEAD GUY                            | FT   | -        |
| AERIAL SLACK LOOP                       | FT   | -        |
| TRENCH 2-1.25" HDPE                     | LF   | -        |
| DIR. BORE 2-1.25" HDPE                  | LF   | 600      |
| DIR. BORE 1-4" HDPE CASING              | LF   | -        |
| 1.25" HDPE                              | FT   | 1200     |
| 10GA TRACER WIRE                        | FT   | 600      |
| 24"X36"X24" HH                          | EA   | -        |
| 3'X5'X4" MH                             | EA   | -        |
| PULL CABLE THRU EXIST. AT&T CONDUIT     | FT   | -        |
| PULL CABLE THRU EXIST. NEXTLINK CONDUIT | FT   | -        |
| 1-4" CORE BORE                          | EA   | -        |
| SLACK COIL IN HH/MH                     | FT   | -        |
| REMOVE & RESTORE CONCRETE S/W           | SF   | -        |
| REMOVE & RESTORE ASPHALT PAVEMENT       | SF   | -        |
| 12ct FIBER OPTIC CABLE (TOTAL)          | FT   | 600      |



CALL BEFORE YOU DIG  
1-800-245-4545  
48 HOURS NOTICE REQUIRED



| REV | DESCRIPTION | BY | APVD | DATE |
|-----|-------------|----|------|------|
| -   | -           | -  | -    | -    |
| -   | -           | -  | -    | -    |
| -   | -           | -  | -    | -    |
| -   | -           | -  | -    | -    |
| -   | -           | -  | -    | -    |
| -   | -           | -  | -    | -    |
| -   | -           | -  | -    | -    |



|                                  |                                     |
|----------------------------------|-------------------------------------|
| PROJECT: SWEETWATER CIRCUIT FEED | PROJECT CODE: LJAT3107-0142         |
| KERENS, TX 75114                 |                                     |
| FIBER OPTIC CABLE BUILD PLAN     |                                     |
| DRAWN LJA/DW                     | DWG NO. -                           |
| APPV -                           | SWEETWATERCIRCUITFEED_KERENS_TX_DWG |
| SHEET: 005 OF 012                | DATE: 09/09/22                      |

NOTE:  
UNDERGROUND UTILITIES HAVE BEEN PLOTTED FROM AVAILABLE  
RECORDS AND FIELD OBSERVATIONS BUT ARE NOT NECESSARILY EXACT.  
IT IS THE CONTRACTOR RESPONSIBILITY TO FIELD LOCATE ALL  
UNDERGROUND OBSTRUCTIONS AND UTILITIES PRIOR TO CONSTRUCTION.  
COMPLETE REPAIR OF ANY AND ALL DAMAGES INCURRED SHALL BE AT  
THE EXPENSE OF THE CONTRACTOR.

NAVARRO COUNTY  
KERENS, TX

CAUTION!!!  
CONTRACTOR TO LOCATE &  
VERIFY ALL EXISTING UTILITIES  
PRIOR TO CONSTRUCTION

CAUTION!!!  
EXIST. BURIED FIBER, TELEPHONE, CATV, GAS, ELECTRIC, WATER,  
SANITARY SEWER & STORM SEWER FACILITIES IN CONSTRUCTION AREA  
AND HAVE NOT BEEN FIELD LOCATED. CONTRACTOR TO VERIFY EXACT  
LOCATION AND DEPTH PRIOR TO ANY DIGGING AND/OR BORING.

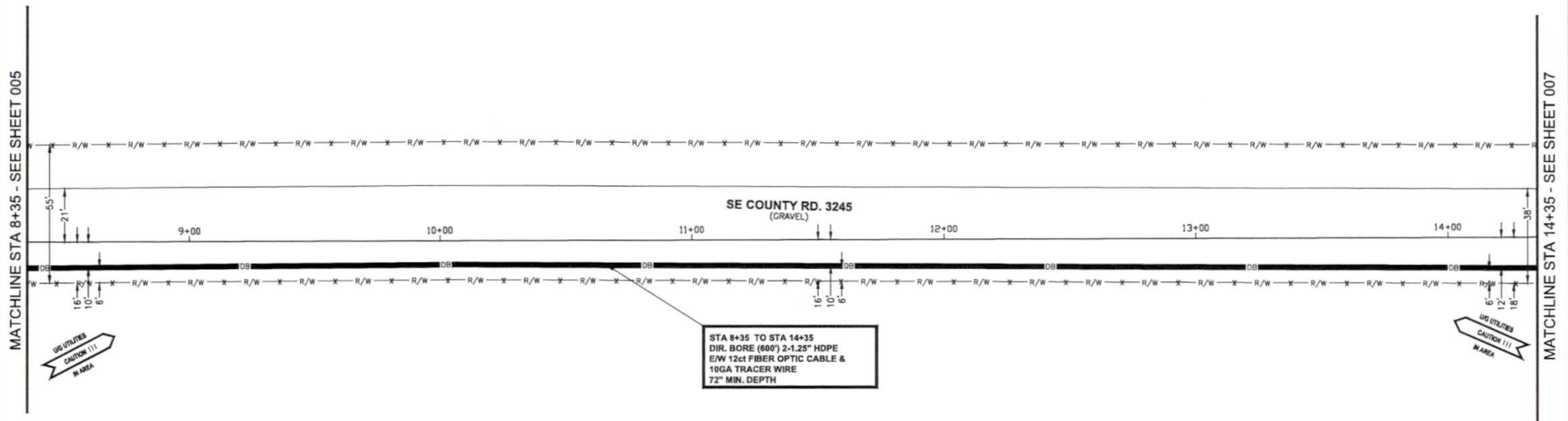

| DESCRIPTION                             | UNIT | QUANTITY |
|---|------|----------|
| 12ct FIBER OPTIC CABLE (AERIAL)         | FT   | -        |
| 12ct FIBER OPTIC CABLE (RISER)          | FT   | -        |
| 12ct FIBER OPTIC CABLE NEW (U/G)        | FT   | 600      |
| 6W STRAND                               | FT   | -        |
| 1-4" GALV. U-GUARD E/W 2-1.25" HDPE     | FT   | -        |
| DOWN GUY & ANCHOR                       | EA   | -        |
| OVERHEAD GUY                            | FT   | -        |
| AERIAL SLACK LOOP                       | FT   | -        |
| TRENCH 2-1.25" HDPE                     | LF   | -        |
| DIR. BORE 2-1.25" HDPE                  | LF   | 600      |
| DIR. BORE 1-4" HDPE CASING              | LF   | -        |
| 1.25" HDPE                              | FT   | 1200     |
| 10GA TRACER WIRE                        | FT   | 600      |
| 24"X36"X24" HH                          | EA   | -        |
| 3"X5'X4" MH                             | EA   | -        |
| PULL CABLE THRU EXIST. AT&T CONDUIT     | FT   | -        |
| PULL CABLE THRU EXIST. NEXTLINK CONDUIT | FT   | -        |
| 1-4" CORE BORE                          | EA   | -        |
| SLACK COIL IN HH/MH                     | FT   | -        |
| REMOVE & RESTORE CONCRETE S/W           | SF   | -        |
| REMOVE & RESTORE ASPHALT PAVEMENT       | SF   | -        |
| 12ct FIBER OPTIC CABLE (TOTAL)          | FT   | 600      |



CALL BEFORE YOU DIG  
1-800-245-4545  
48 HOURS NOTICE REQUIRED



| REV | DESCRIPTION | BY | APVD | DATE |
|-----|-------------|----|------|------|
| -   | -           | -  | -    | -    |
| -   | -           | -  | -    | -    |
| -   | -           | -  | -    | -    |
| -   | -           | -  | -    | -    |
| -   | -           | -  | -    | -    |
| -   | -           | -  | -    | -    |



|   |                            |
|---|----------------------------|
| PALMIST: SWEETWATER CIRCUIT FEED                | PROJECT NAME: LJA3107-0142 |
| KERENS, TX 75114                                |                            |
| FIBER OPTIC CABLE BUILD                         |                            |
| PLAN  |                            |
| DRAWN: LJA/GM                                   | DATE: 09/05/22             |
| APPROV: SWEETWATERCIRCUITFEED_KERENS_TX_006.DWG |                            |
| SHEETS: 006 OF 012                              | APPROVED: 09/05/22         |



NOTE:  
UNDERGROUND UTILITIES HAVE BEEN PLOTTED FROM AVAILABLE  
RECORDS AND FIELD OBSERVATIONS BUT ARE NOT NECESSARILY EXACT.  
IT IS THE CONTRACTOR RESPONSIBILITY TO FIELD LOCATE ALL  
UNDERGROUND OBSTRUCTIONS AND UTILITIES PRIOR TO CONSTRUCTION.  
COMPLETE REPAIR OF ANY AND ALL DAMAGES INCURRED SHALL BE AT  
THE EXPENSE OF THE CONTRACTOR.

NAVARRO COUNTY  
KERENS, TX

CAUTION !!!  
CONTRACTOR TO LOCATE &  
VERIFY ALL EXISTING UTILITIES  
PRIOR TO CONSTRUCTION

CAUTION!!!  
EXIST. BURIED FIBER, TELEPHONE, CATV, GAS, ELECTRIC, WATER,  
SANITARY SEWER & STORM SEWER FACILITIES IN CONSTRUCTION AREA  
AND HAVE NOT BEEN FIELD LOCATED. CONTRACTOR TO VERIFY EXACT  
LOCATION AND DEPTH PRIOR TO ANY DIGGING AND/OR BORING.



MATCHLINE STA 14+35 - SEE SHEET 006

MATCHLINE STA 20+35 - SEE SHEET 008

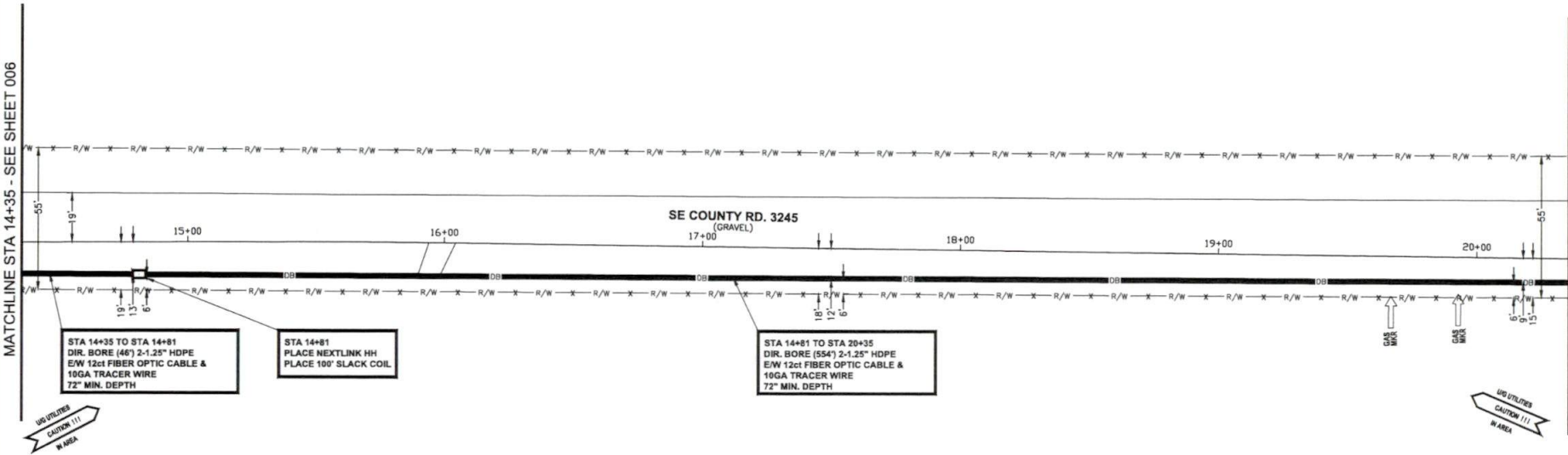

| DESCRIPTION                             | UNIT | QUANTITY |
|---|------|----------|
| 12ct FIBER OPTIC CABLE (AERIAL)         | FT   | -        |
| 12ct FIBER OPTIC CABLE (RISER)          | FT   | -        |
| 12ct FIBER OPTIC CABLE NEW (U/G)        | FT   | 600      |
| 6M STRAND                               | FT   | -        |
| 1-4" GALV. U-GUARD E/W 2-1.25" HDPE     | FT   | -        |
| DOWN GUY & ANCHOR                       | EA   | -        |
| OVERHEAD GUY                            | FT   | -        |
| AERIAL SLACK LOOP                       | FT   | -        |
| TRENCH 2-1.25" HDPE                     | LF   | -        |
| DIR. BORE 2-1.25" HDPE                  | LF   | 600      |
| DIR. BORE 1-4" HDPE CASING              | LF   | -        |
| 1.25" HDPE                              | FT   | 1200     |
| 10GA TRACER WIRE                        | FT   | 600      |
| 24"X36"X24" HH                          | EA   | 1        |
| 3'X5'X4" MH                             | EA   | -        |
| PULL CABLE THRU EXIST. AT&T CONDUIT     | FT   | -        |
| PULL CABLE THRU EXIST. NEXTLINK CONDUIT | FT   | -        |
| 1-4" CORE BORE                          | EA   | -        |
| SLACK COIL IN HH/MH                     | FT   | 100      |
| REMOVE & RESTORE CONCRETE S/W           | SF   | -        |
| REMOVE & RESTORE ASPHALT PAVEMENT       | SF   | -        |
| 12ct FIBER OPTIC CABLE (TOTAL)          | FT   | 700      |



CALL BEFORE YOU DIG  
1-800-243-4343  
48 HOURS NOTICE REQUIRED



| REV | DESCRIPTION | BY | APVD | DATE |
|-----|-------------|----|------|------|
| -   | -           | -  | -    | -    |
| -   | -           | -  | -    | -    |
| -   | -           | -  | -    | -    |
| -   | -           | -  | -    | -    |
| -   | -           | -  | -    | -    |
| -   | -           | -  | -    | -    |
| -   | -           | -  | -    | -    |



|                                     |                             |
|-------------------------------------|-----------------------------|
| PROJECT: SWEETWATER CIRCUIT FEED    | PROJECT NAME: LJA13107-0142 |
| KERENS, TX 75114                    |                             |
| TITLE: FIBER OPTIC CABLE BUILD PLAN |                             |
| DRAWN: LJA/GW                       | DATE: 08/28/22              |
| APPROVED: [Signature]               | DATE: 08/28/22              |
| SHEET: 007 OF 012                   | DATE: 08/28/22              |

NOTE:  
UNDERGROUND UTILITIES HAVE BEEN PLOTTED FROM AVAILABLE RECORDS AND FIELD OBSERVATIONS BUT ARE NOT NECESSARILY EXACT. IT IS THE CONTRACTOR RESPONSIBILITY TO FIELD LOCATE ALL UNDERGROUND OBSTRUCTIONS AND UTILITIES PRIOR TO CONSTRUCTION. COMPLETE REPAIR OF ANY AND ALL DAMAGES INCURRED SHALL BE AT THE EXPENSE OF THE CONTRACTOR.

NAVARRO COUNTY  
KERENS, TX

CAUTION !!!  
CONTRACTOR TO LOCATE &  
VERIFY ALL EXISTING UTILITIES  
PRIOR TO CONSTRUCTION

CAUTION !!!  
EXIST. BURIED FIBER, TELEPHONE, CATV, GAS, ELECTRIC, WATER,  
SANITARY SEWER & STORM SEWER FACILITIES IN CONSTRUCTION AREA  
AND HAVE NOT BEEN FIELD LOCATED, CONTRACTOR TO VERIFY EXACT  
LOCATION AND DEPTH PRIOR TO ANY DIGGING AND/OR BORING.



MATCHLINE STA 20+35 - SEE SHEET 007

MATCHLINE STA 25+86 - SEE SHEET 009

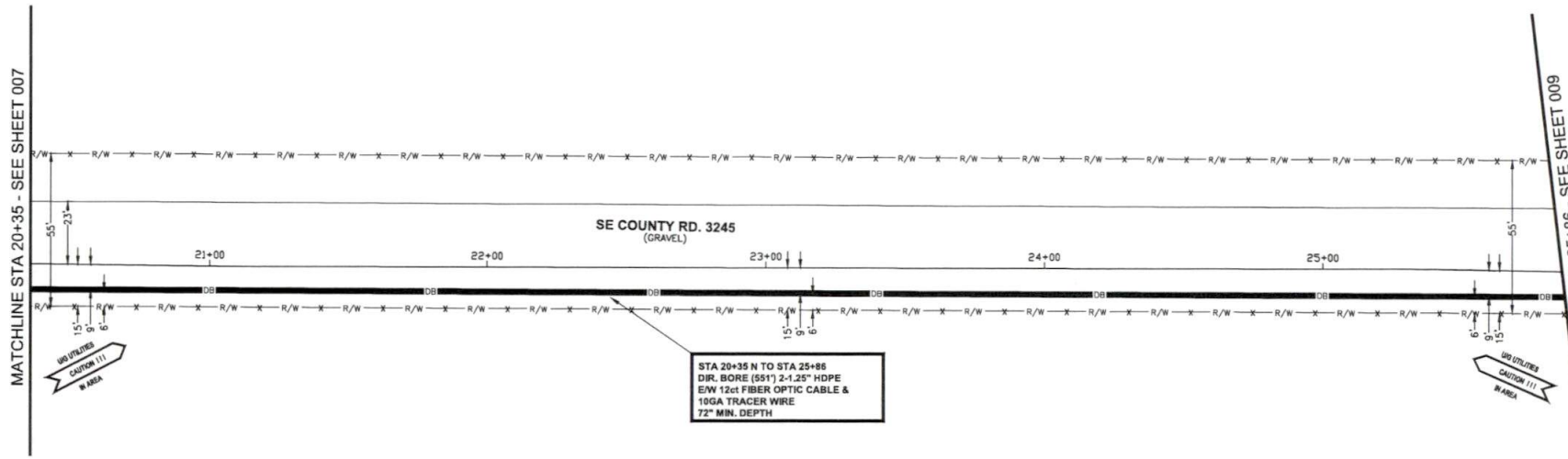

| DESCRIPTION                             | UNIT | QUANTITY |
|---|------|----------|
| 12ct FIBER OPTIC CABLE (AERIAL)         | FT   | —        |
| 12ct FIBER OPTIC CABLE (RISER)          | FT   | —        |
| 12ct FIBER OPTIC CABLE NEW (U/G)        | FT   | 551      |
| 6M STRAND                               | FT   | —        |
| 1-4\" GALV. U-GUARD E/W 2-1.25\" HDPE   | FT   | —        |
| DOWN GUY & ANCHOR                       | EA   | 1        |
| OVERHEAD GUY                            | FT   | —        |
| AERIAL SLACK LOOP                       | FT   | —        |
| TRENCH 2-1.25\" HDPE                    | LF   | —        |
| DIR. BORE 2-1.25\" HDPE                 | LF   | 551      |
| DIR. BORE 1-4\" HDPE CASING             | LF   | —        |
| 1.25\" HDPE                             | FT   | 1102     |
| 10GA TRACER WIRE                        | FT   | 551      |
| 24\"X36\"X24\" HH                       | EA   | —        |
| 3\"X5\"X4\" MH                          | EA   | —        |
| PULL CABLE THRU EXIST. AT&T CONDUIT     | FT   | —        |
| PULL CABLE THRU EXIST. NEXTLINK CONDUIT | FT   | —        |
| 1-4\" CORE BORE                         | EA   | —        |
| SLACK COIL IN HH/MH                     | FT   | —        |
| REMOVE & RESTORE CONCRETE S/W           | SF   | —        |
| REMOVE & RESTORE ASPHALT PAVEMENT       | SF   | —        |
| 12ct FIBER OPTIC CABLE (TOTAL)          | FT   | 551      |



CALL BEFORE YOU DIG  
1-800-243-4345  
48 HOURS NOTICE REQUIRED



| REV | DESCRIPTION | BY | APVD | DATE |
|-----|-------------|----|------|------|
| —   | —           | —  | —    | —    |
| —   | —           | —  | —    | —    |
| —   | —           | —  | —    | —    |
| —   | —           | —  | —    | —    |
| —   | —           | —  | —    | —    |
| —   | —           | —  | —    | —    |
| —   | —           | —  | —    | —    |



INFORMATION ON THIS DOCUMENT  
IS PRELIMINARY AND SHALL NOT  
BE USED FOR ANY PURPOSES  
OTHER THAN THAT OF A GUIDE  
UNLESS SPECIFICALLY NOTED OTHERWISE

|                                     |                            |
|-------------------------------------|----------------------------|
| PROJECT: SWEETWATER CIRCUIT FEED    | PROJECT DWG: LJA13107-0142 |
| KERENS, TX 75114                    |                            |
| TITLE: FIBER OPTIC CABLE BUILD PLAN |                            |
| DRAWN LJA/GH                        | CHKD: —                    |
| APPV: —                             | DATE: 08/09/22             |
| SHEET: 008 OF 012                   | DATE: 08/09/22             |

NAVARRO COUNTY  
KERENS, TX

CAUTION !!!  
CONTRACTOR TO LOCATE &  
VERIFY ALL EXISTING UTILITIES  
PRIOR TO CONSTRUCTION

CAUTION!!!  
EXIST. BURIED FIBER, TELEPHONE, CATV, GAS, ELECTRIC, WATER,  
SANITARY SEWER & STORM SEWER FACILITIES IN CONSTRUCTION AREA  
AND HAVE NOT BEEN FIELD LOCATED. CONTRACTOR TO VERIFY EXACT  
LOCATION AND DEPTH PRIOR TO ANY DIGGING AND/OR BORING.

NOTE:  
UNDERGROUND UTILITIES HAVE BEEN PLOTTED FROM AVAILABLE  
RECORDS AND FIELD OBSERVATIONS BUT ARE NOT NECESSARILY EXACT.  
IT IS THE CONTRACTOR RESPONSIBILITY TO FIELD LOCATE ALL  
UNDERGROUND OBSTRUCTIONS AND UTILITIES PRIOR TO CONSTRUCTION.  
COMPLETE REPAIR OF ANY AND ALL DAMAGES INCURRED SHALL BE AT  
THE EXPENSE OF THE CONTRACTOR.



MATCHLINE STA 25+86 - SEE SHEET 008

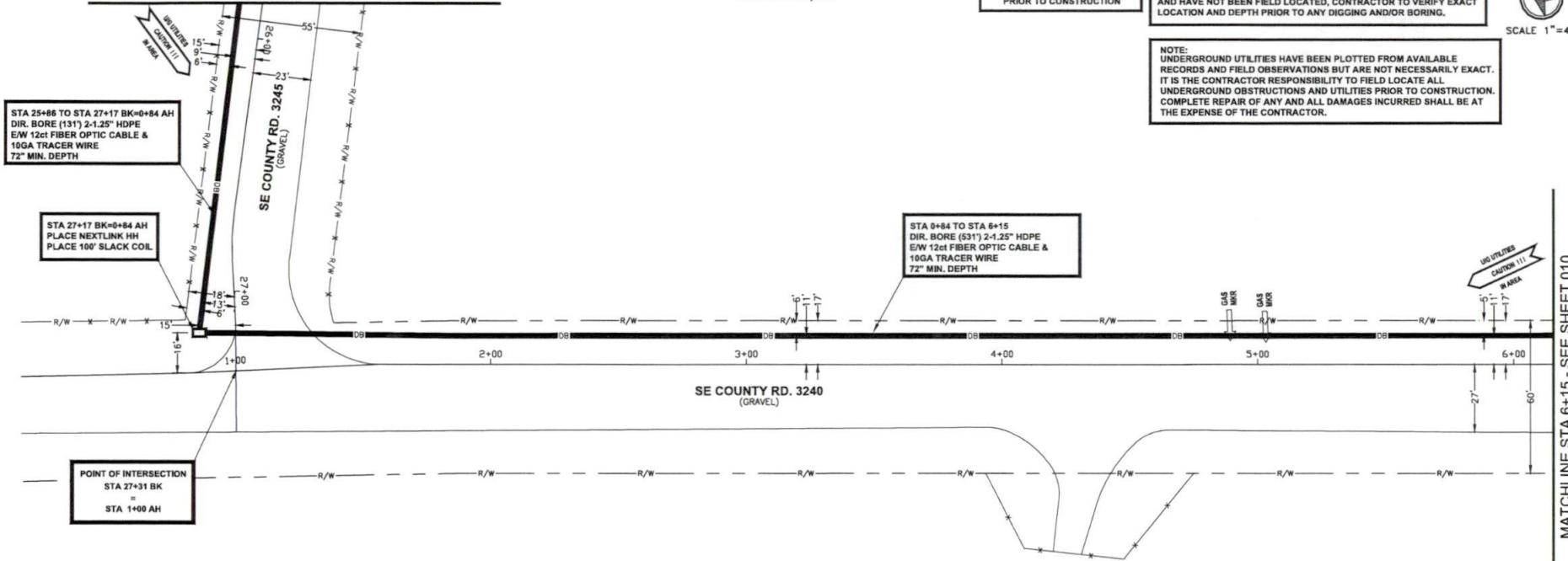

| DESCRIPTION                             | UNIT | QUANTITY |
|---|------|----------|
| 12ct FIBER OPTIC CABLE (AERIAL)         | FT   | —        |
| 12ct FIBER OPTIC CABLE (RISER)          | FT   | —        |
| 12ct FIBER OPTIC CABLE NEW (U/G)        | FT   | 662      |
| 6M STRAND                               | FT   | —        |
| 1-4" GALV U-GUARD E/W 2-1.25" HDPE      | FT   | —        |
| DOWN GUY & ANCHOR                       | EA   | —        |
| OVERHEAD GUY                            | EA   | —        |
| AERIAL SLACK LOOP                       | FT   | —        |
| TRENCH 2-1.25" HDPE                     | LF   | —        |
| DIR. BORE 2-1.25" HDPE                  | LF   | 662      |
| DIR. BORE 1-4" HDPE CASING              | LF   | 1324     |
| 1.25" HDPE                              | FT   | 662      |
| 10GA TRACER WIRE                        | EA   | 1        |
| 24"x36"x24" HH                          | EA   | 662      |
| 3'X5'X4" MH                             | EA   | —        |
| PULL CABLE THRU EXIST. AT&T CONDUIT     | FT   | —        |
| PULL CABLE THRU EXIST. NEXTLINK CONDUIT | FT   | —        |
| 1-4" CORE BORE                          | EA   | —        |
| SLACK COIL IN HH/MH                     | FT   | 100      |
| REMOVE & RESTORE CONCRETE S/W           | SF   | —        |
| REMOVE & RESTORE CONCRETE PAVEMENT      | SF   | —        |
| REMOVE & RESTORE ASPHALT PAVEMENT       | SF   | —        |
| 12ct FIBER OPTIC CABLE (TOTAL)          | FT   | 762      |



CALL BEFORE YOU DIG  
1-800-545-4545  
48 HOURS NOTICE REQUIRED

ENGINEERING CONTRACTOR



| REV | DESCRIPTION | BY | APVD | DATE |
|-----|-------------|----|------|------|
| 1   |             |    |      |      |
| 2   |             |    |      |      |
| 3   |             |    |      |      |
| 4   |             |    |      |      |
| 5   |             |    |      |      |
| 6   |             |    |      |      |
| 7   |             |    |      |      |
| 8   |             |    |      |      |
| 9   |             |    |      |      |
| 10  |             |    |      |      |



|  |                             |
|--|-----------------------------|
| PROJECT: SWEETWATER CIRCUIT FEED                     | PROJECT DRWG: LJA13107-0142 |
| KERENS, TX 75114                                     |                             |
| TITLE: FIBER OPTIC CABLE BUILD PLAN                  |                             |
| DRAWN LJA/GM   | DATE: 08/09/22              |
| APPROVED: SWEETWATER/DRUG/FEED, KERENS, TX, 0009.DWG | REV: -                      |
| SHEETS: 009 OF 012                                   | APPROVED ORIGINAL: 08/09/22 |

MATCHLINE STA 6+15 - SEE SHEET 010

NAVARRO COUNTY  
KERENS, TX

**CAUTION!!!**  
EXIST. BURIED FIBER, TELEPHONE, CATV, GAS, ELECTRIC, WATER,  
SANITARY SEWER & STORM SEWER FACILITIES IN CONSTRUCTION AREA  
AND HAVE NOT BEEN FIELD LOCATED, CONTRACTOR TO VERIFY EXACT  
LOCATION AND DEPTH PRIOR TO ANY DIGGING AND/OR BORING.



SCALE 1"=40'

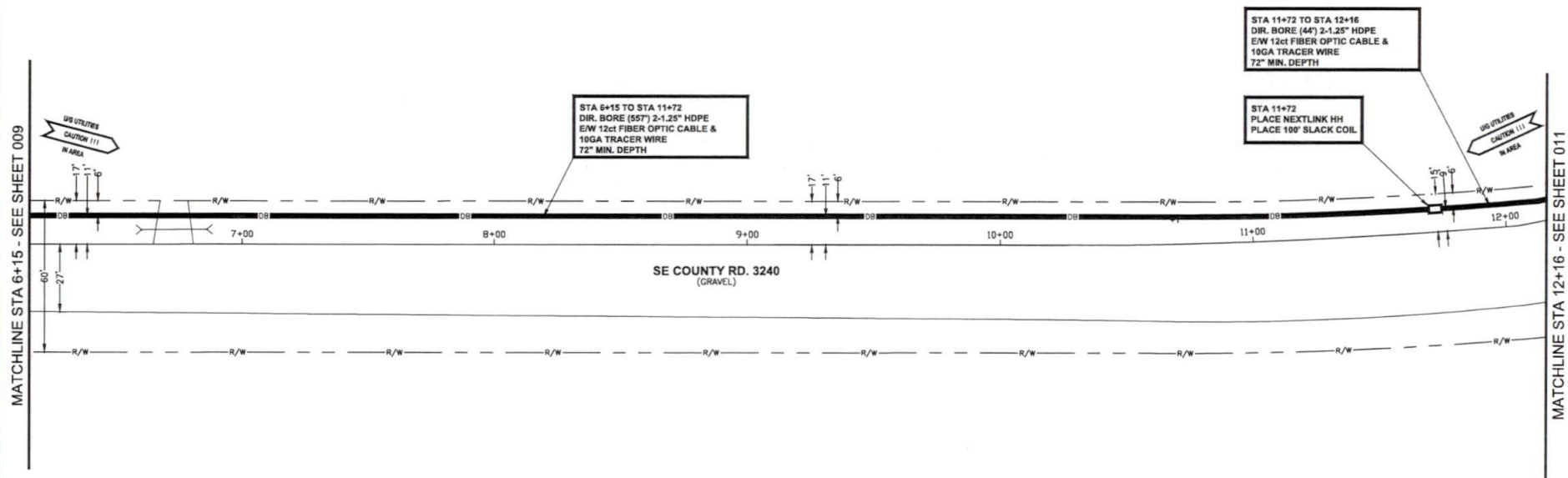

| DESCRIPTION                             | UNIT | QUANTITY |
|---|------|----------|
| 12c1t FIBER OPTIC CABLE (AERIAL)        | FT   | —        |
| 12c1t FIBER OPTIC CABLE (RISER)         | FT   | —        |
| 12c1t FIBER OPTIC CABLE NEW (U/G)       | FT   | 601      |
| 6M STRAND                               | FT   | —        |
| 1-4" GALV. U-ANCHOR E/W 2-1.25" HDPE    | EA   | —        |
| DOWN GUY & GANCH                        | FT   | —        |
| OVERHEAD GUY                            | FT   | —        |
| AERIAL SLACK LOOP                       | FT   | —        |
| TRENCH 2-1.25" HDPE                     | LF   | —        |
| DIR. BORE 2-1.25" HDPE                  | LF   | 601      |
| DIR. BORE 1-4" HDPE CASING              | LF   | —        |
| 1.25" HDPE                              | FT   | 1202     |
| LOGA TRACER WIRE                        | EA   | 61       |
| 24"x36"x24" HH                          | EA   | 1        |
| 3'X5'X4" MH                             | EA   | —        |
| PULL CABLE THRU EXIST. AT&T CONDUIT     | FT   | —        |
| PULL CABLE THRU EXIST. NEXTLINK CONDUIT | FT   | —        |
| 1-4" CORE BORE                          | EA   | —        |
| SLACK OFF IN HH/MH                      | FT   | 100      |
| REMOVE & RESTORE CONCRETE S/W           | SF   | —        |
| REMOVE & RESTORE CONCRETE PAVEMENT      | SF   | —        |
| REMOVE & RESTORE ASPHALT PAVEMENT       | SF   | —        |
| 12c1t FIBER OPTIC CABLE (TOTAL)         | FT   | 701      |



CALL BEFORE YOU DIG  
1-800-245-4545  
48 HOURS NOTICE REQUIRED

[illegible]

INFORMATION ON THIS DOCUMENT  
IS PROPRIETARY AND SHALL NOT  
BE USED, COPIED, REPRODUCED OR  
DISCLOSED IN WHOLE OR IN PART

|                  |   |     |               |               |
|------------------|---|-----|---------------|---------------|
| PROJECT:         | SWEETWATER CIRCUIT FEED                 |     | PROJECT CODE: | LJAT3107-0142 |
| KERENS, TX 75114 |   |     |               |               |
| TITLE:           | FIBER OPTIC CABLE BUILD PLAN            |     |               |               |
| -                |   |     |               |               |
| DRAWN LJA/GW     | DWG NO:                                 | REV |               |               |
| APPV -           | SWEETWATERCIRCUITFEED_KERENS_TX_010.DWG | -   |               |               |



NOTE:  
UNDERGROUND UTILITIES HAVE BEEN PLOTTED FROM AVAILABLE RECORDS AND FIELD OBSERVATIONS BUT ARE NOT NECESSARILY EXACT. IT IS THE CONTRACTOR RESPONSIBILITY TO FIELD LOCATE ALL UNDERGROUND OBSTRUCTIONS AND UTILITIES PRIOR TO CONSTRUCTION. COMPLETE REPAIR OF ANY AND ALL DAMAGES INCURRED SHALL BE AT THE EXPENSE OF THE CONTRACTOR.

NAVARRO COUNTY  
KERENS, TX

CAUTION !!!  
CONTRACTOR TO LOCATE &  
VERIFY ALL EXISTING UTILITIES  
PRIOR TO CONSTRUCTION

CAUTION !!!  
EXIST. BURIED FIBER, TELEPHONE, CATV, GAS, ELECTRIC, WATER,  
SANITARY SEWER & STORM SEWER FACILITIES IN CONSTRUCTION AREA  
AND HAVE NOT BEEN FIELD LOCATED. CONTRACTOR TO VERIFY EXACT  
LOCATION AND DEPTH PRIOR TO ANY DIGGING AND/OR BORING.

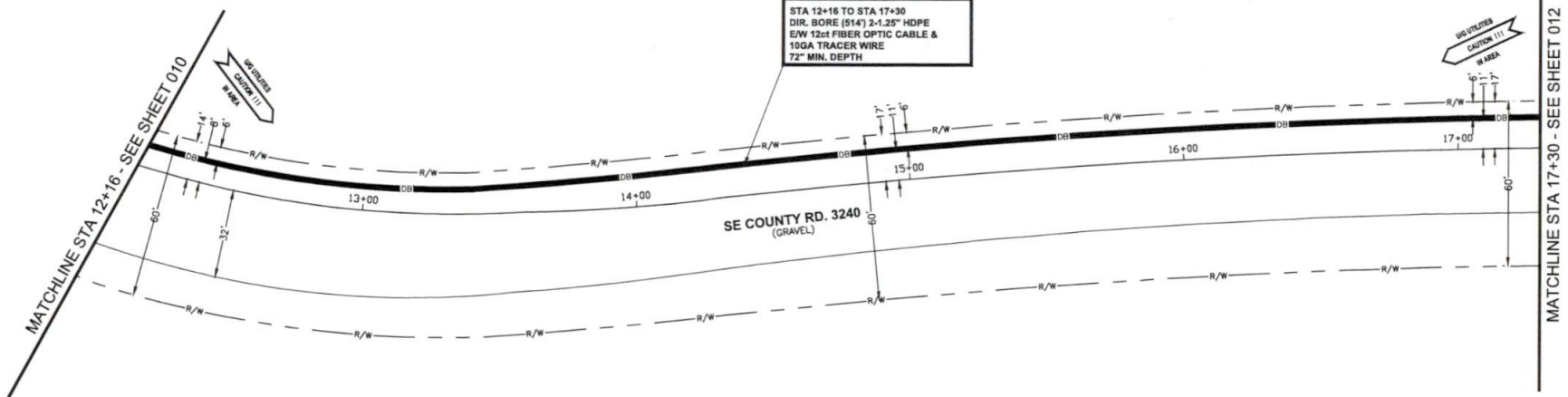

| DESCRIPTION                             | UNIT | QUANTITY |
|---|------|----------|
| 12ct FIBER OPTIC CABLE (AERIAL)         | FT   | -        |
| 12ct FIBER OPTIC CABLE (RISER)          | FT   | -        |
| 12ct FIBER OPTIC CABLE NEW (U/G)        | FT   | 514      |
| 6M STRAND                               | FT   | -        |
| 1-4\" GALV. U-GUARD E/W 2-1.25\" HDPE   | FT   | -        |
| DOWNGUY & ANCHOR                        | EA   | 1        |
| OVERHEAD GUY                            | FT   | -        |
| AERIAL SLACK LOOP                       | FT   | -        |
| TRENCH 2-1.25\" HDPE                    | LF   | -        |
| DIR. BORE 2-1.25\" HDPE                 | LF   | 514      |
| DIR. BORE 1-4\" HDPE CASING             | LF   | -        |
| 1.25\" HDPE                             | FT   | 1028     |
| 10GA TRACER WIRE                        | FT   | 514      |
| 24\"X36\"X24\" HH                       | EA   | -        |
| 3'X5'X4\" MH                            | EA   | -        |
| PULL CABLE THRU EXIST. AT&T CONDUIT     | FT   | -        |
| PULL CABLE THRU EXIST. NEXTLINK CONDUIT | FT   | -        |
| 1-4\" CORE BORE                         | EA   | -        |
| SLACK COIL IN HH/MH                     | FT   | -        |
| REMOVE & RESTORE CONCRETE S/W           | SF   | -        |
| REMOVE & RESTORE ASPHALT PAVEMENT       | SF   | -        |
| 12ct FIBER OPTIC CABLE (TOTAL)          | FT   | 514      |



CALL BEFORE YOU DIG  
1-800-243-4343  
48 HOURS NOTICE REQUIRED



| REV | DESCRIPTION | BY | APVD | DATE |
|-----|-------------|----|------|------|
| -   | -           | -  | -    | -    |
| -   | -           | -  | -    | -    |
| -   | -           | -  | -    | -    |
| -   | -           | -  | -    | -    |
| -   | -           | -  | -    | -    |
| -   | -           | -  | -    | -    |
| -   | -           | -  | -    | -    |



INFORMATION ON THIS DOCUMENT  
IS FOR INFORMATION ONLY AND NOT  
TO BE USED FOR CONSTRUCTION OR  
OPERATIONS. IT IS THE USER'S  
SOLE RESPONSIBILITY TO OBTAIN  
NECESSARY PERMITS AND  
CONSULT WITH THE APPROPRIATE  
AGENCIES.

|                                     |                            |
|-------------------------------------|----------------------------|
| PROJECT: SWEETWATER CIRCUIT FEED    | PROJECT NAME: LJA3107-0142 |
| KERENS, TX 75114                    |                            |
| TITLE: FIBER OPTIC CABLE BUILD PLAN |                            |
| DRAWN: LJA/CW                       | DATE: 05/09/22             |
| APPROVED: [Signature]               |                            |
| SHEET: 011 OF 012                   |                            |

NOTE:  
UNDERGROUND UTILITIES HAVE BEEN PLOTTED FROM AVAILABLE  
RECORDS AND FIELD OBSERVATIONS BUT ARE NOT NECESSARILY EXACT.  
IT IS THE CONTRACTOR RESPONSIBILITY TO FIELD LOCATE ALL  
UNDERGROUND OBSTRUCTIONS AND UTILITIES PRIOR TO CONSTRUCTION.  
COMPLETE REPAIR OF ANY AND ALL DAMAGES INCURRED SHALL BE AT  
THE EXPENSE OF THE CONTRACTOR.

NAVARRO COUNTY  
KERENS, TX

CAUTION !!!  
CONTRACTOR TO LOCATE &  
VERIFY ALL EXISTING UTILITIES  
PRIOR TO CONSTRUCTION

CAUTION!!!  
EXIST. BURIED FIBER, TELEPHONE, CATV, GAS, ELECTRIC, WATER,  
SANITARY SEWER & STORM SEWER FACILITIES IN CONSTRUCTION AREA  
AND HAVE NOT BEEN FIELD LOCATED. CONTRACTOR TO VERIFY EXACT  
LOCATION AND DEPTH PRIOR TO ANY DIGGING AND/OR BORING.

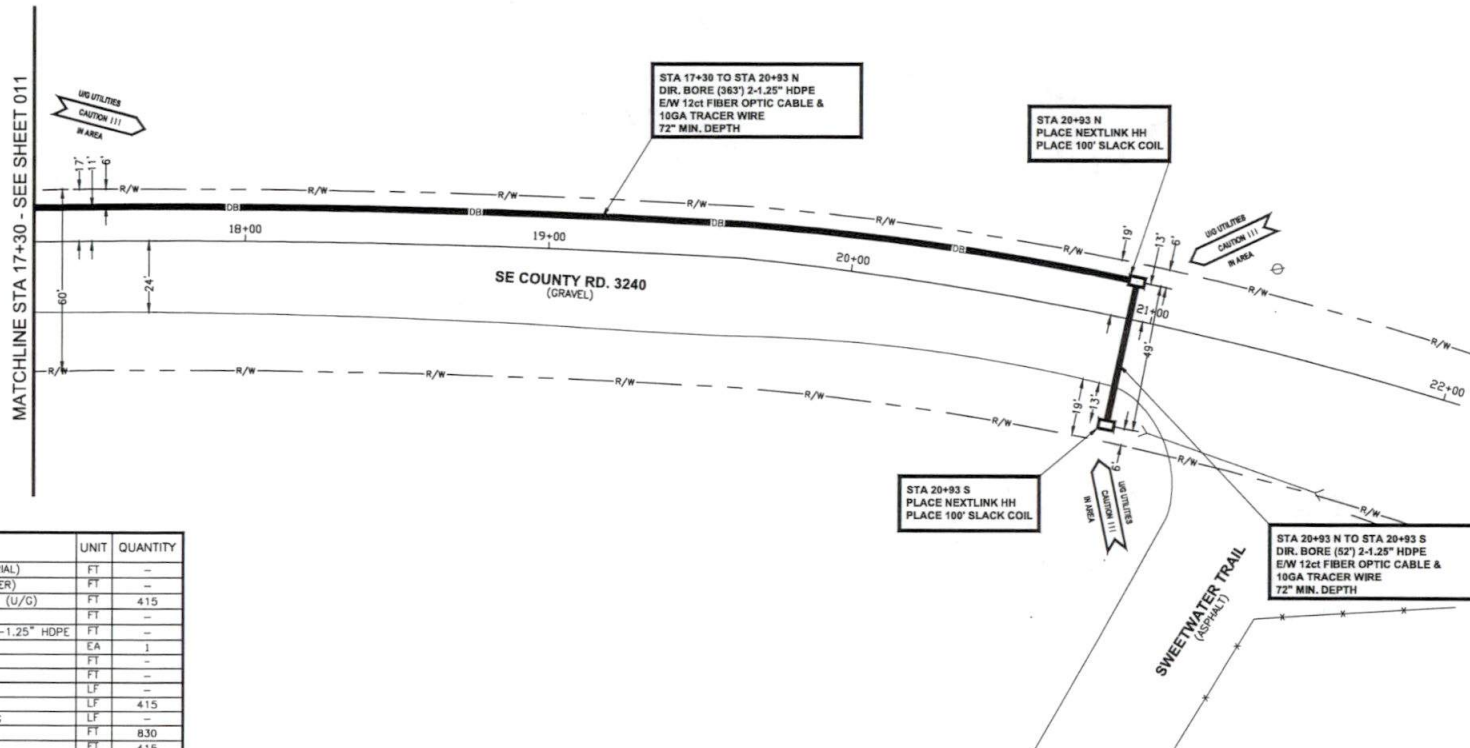

| DESCRIPTION                             | UNIT | QUANTITY |
|---|------|----------|
| 12ct FIBER OPTIC CABLE (AERIAL)         | FT   | -        |
| 12ct FIBER OPTIC CABLE (RISER)          | FT   | -        |
| 12ct FIBER OPTIC CABLE NEW (U/G)        | FT   | 415      |
| 6M STRAND                               | FT   | -        |
| 1-4" GALV. U-GUARD E/W 2-1.25" HDPE     | EA   | 1        |
| DOWN GUY & ANCHOR                       | FT   | -        |
| OVERHEAD GUY                            | FT   | -        |
| AERIAL SLACK LOOP                       | FT   | -        |
| TRENCH 2-1.25" HDPE                     | LF   | -        |
| DIR. BORE 2-1.25" HDPE                  | LF   | 415      |
| DIR. BORE 1-4" HDPE CASING              | LF   | -        |
| 1.25" HDPE                              | FT   | 830      |
| 10GA TRACER WIRE                        | FT   | 415      |
| 24"x36"x24" HH                          | EA   | 2        |
| 3'X5'X4" MH                             | EA   | -        |
| PULL CABLE THRU EXIST. AT&T CONDUIT     | FT   | -        |
| PULL CABLE THRU EXIST. NEXTLINK CONDUIT | FT   | -        |
| 1-4" CORE BORE                          | EA   | -        |
| SLACK COIL IN HH/MH                     | FT   | 200      |
| REMOVE & RESTORE CONCRETE S/W           | SF   | -        |
| REMOVE & RESTORE CONCRETE PAVEMENT      | SF   | -        |
| REMOVE & RESTORE ASPHALT PAVEMENT       | SF   | -        |
| 12ct FIBER OPTIC CABLE (TOTAL)          | FT   | 615      |



CALL BEFORE YOU DIG  
1-800-245-4545  
48 HOURS NOTICE REQUIRED



| REV | DESCRIPTION | BY | APVD | DATE |
|-----|-------------|----|------|------|
| 1   |             |    |      |      |
| 2   |             |    |      |      |
| 3   |             |    |      |      |
| 4   |             |    |      |      |
| 5   |             |    |      |      |
| 6   |             |    |      |      |
| 7   |             |    |      |      |
| 8   |             |    |      |      |
| 9   |             |    |      |      |
| 10  |             |    |      |      |



INFORMATION ON THIS DOCUMENT  
IS PRELIMINARY AND SUBJECT TO  
CHANGE WITHOUT NOTICE. NO  
WARRANTY IS MADE ON THE PART  
OF THE ENGINEER OR CONTRACTOR.

|                                     |                             |
|-------------------------------------|-----------------------------|
| PROJECT: SWEETWATER CIRCUIT FEED    | PROJECT CODE: LJA13107-0142 |
| KERENS, TX 75114                    |                             |
| TITLE: FIBER OPTIC CABLE BUILD PLAN |                             |
| DRAWN: LJA/GM                       | DATE: 08/05/22              |
| APPV: -                             | REV: -                      |
| SHEET: 019 OF 012                   | APPROVED: 08/05/22          |